



Life is Precious.
Be Safe.

Koopers Distribution Sdn Bhd

☎ 03-78324338

🌐 www.koopers.co

📘 www.facebook.com/koopersmalaysia

✉ sales@koopers.co

📍 8, Jalan Zuhal U5/178, Seksyen U5, Bandar Pinggiran Subang
40150 Shah Alam, Selangor, Malaysia



SPARK⁺

40 - 150 cm

Birth to 12 yrs

Instruction Manual

1. Warning	01
2. Components	02
3. Use in the vehicle	03
4. Preparatory works	04-10
4.1 Adjusting buckle	
4.2 Adjusting harness	
4.3 Adjusting headrest	
4.4 Adjusting recline positions	
4.5 Adjusting anti-rebound bar	
4.6 Rotating seat	
4.7 Adjusting ISOFIX	
4.8 Install the support leg	
4.9 Remove and install harness	
4.10 Install and remove side impact shield	
5. Installation	11-14
5.1 Rearward facing 40-105cm (born to approx. 4 Years, ≤ 18 kg)	
5.2 Forward facing 76-105cm (15 months to approx. 4 years, ≤ 18 kg)	
5.3 Forward facing 100-150cm (approx. 3 years to 12 years)	
6. Cleaning	14
7. Customer service	15

For using as i-Size category Enhanced Child Restraint System

Notice:

This is an i-Size Enhanced Child Restraint System. It is approved according to UN Regulation No 129, for use in, i-Size compatible vehicle seating positions as indicated by vehicle manufacturers in the vehicle users' manual.

If in doubt, consult either the Enhanced Child Restraint System manufacturer or the retailer.

For using as i-Size booster seat category Enhanced Child Restraint System

Notice:

This is a i-Size booster seat Enhanced Child Restraint System. It is approved according to UN Regulation No 129, for use primarily in "i-Size seating positions" as indicated by vehicle manufacturers in the vehicle user's manual.

If in doubt, consult either the Enhanced Child Restraint System manufacturer or the retailer.

- The rigid items and plastic parts of an Enhanced Child Restraint System shall be located and installed so that they are not liable to become trapped by a movable seat or in a door of the vehicle during everyday use of the vehicle;
- Any straps holding the restraint to the vehicle should be tight, that any straps restraining the child should be adjusted to the child's body, and that straps should not be twisted;
- Ensure that any lap strap is worn low down, so that the pelvis is firmly engaged, shall be stressed.
- The device should be replaced when it has been subject to violent stresses in an accident;
- It is dangerous of making any alterations or additions to the device without the approval of the Type Approval Authority, and a danger of not following closely the installation instructions provided by the child restraint manufacturer;
- When the chair is not provided with a textile cover, the chair should be kept away from sunlight, otherwise it may be too hot for the child's skin;
- Children are not left in their Enhanced Child Restraint System unattended;
- Any luggage or other objects liable to cause injuries in the event of a collision shall be properly secured.
- The Enhanced Child Restraint System shall not be used without the cover;
- The Enhanced Child Restraint System cover should not be replaced with any other than the one recommended by the manufacturer, because the cover constitutes an integral part of the restraint performance.
- Retain the instructions on the child restraint for its life period.
- For an "i-Size Enhanced Child Restraint System", the user shall also be referred to the vehicle manufacturer's handbook."

2. COMPONENTS



3. USE IN THE VEHICLE

Please observe the instructions for using children's restraining systems in the operating instructions of your vehicle. During use, be sure to observe any restrictions relating to airbags. Please refer to the operating instructions for your vehicle for information about vehicle seats which are certified for the use of children's restraining systems according to ECE R16.

This is an i-Size Enhanced Child Restraint System. It is approved to Regulation UN R129/03, for use in i-Size compatible vehicle seating positions as indicated by vehicle manufacturers in the vehicle users' manual. If your vehicle does not have an i-Size seating position, please check the vehicle type list that is included.

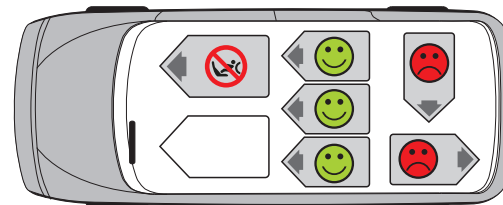
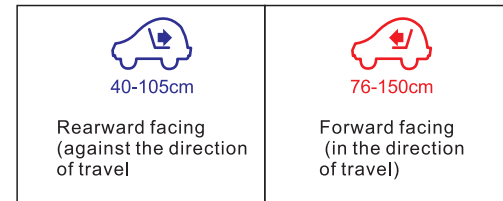

"IMPORTANT – DO NOT USE FORWARD FACING BEFORE THE CHILD'S AGE EXCEEDS 15 MONTHS (Refer to instructions)".

DO NOT place rear-facing child seat on front seat with active airbag, **DEATH OR SERIOUS INJURY** can occur.

4. PREPARATORY WORKS

4.1 Adjusting buckle

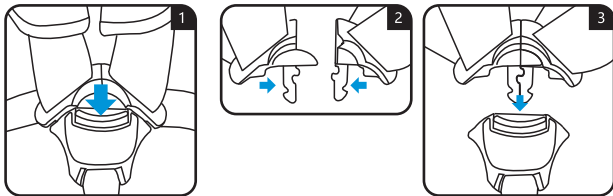

Open buckle

Press red button until buckle latches come out from the buckle.(fig.1)

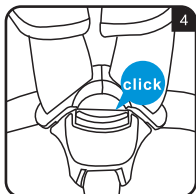

Lock buckle

Guide the two buckle latches together (fig.2), putting them into the harness buckle house (fig.3). Buckle locked when sounds click (fig.4).

Notice: buckle can not lock only by putting one latch.

4.2 Adjusting harness

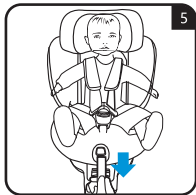

Tighten harness

Pull the adjuster strap until the harness lies flat and is close against your child's body (fig.5).

Notice: Make sure the space between the child and the shoulder harness is about the thickness of one hand.

Loosen harness

Press the center adjuster and at the same time pull both shoulder belts forwards.(fig.6) Do not pull on the shoulder pads

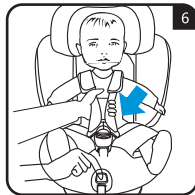

4. PREPARATORY WORKS

4.3 Adjusting headrest

Important ! A correctly adjusted headrest ensures optimal protection for your child in the safety seat.

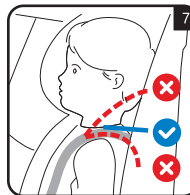

When installed by 5-point harness, the headrest must be adjusted so that the shoulder belts are at the same level as your child's shoulders.(fig.7)

CAUTION! The shoulder belts must not run behind the back of the child or at ear height or above the ears.

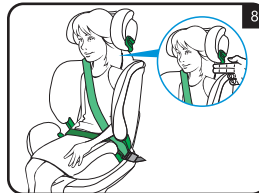

When installed by 3-point vehicle belt, The headrest must be adjusted so that there is a space two fingers wide between the headrest and your child's shoulders. Make sure the diagonal seat belt section is on child's shoulder but not on neck. (fig.8)

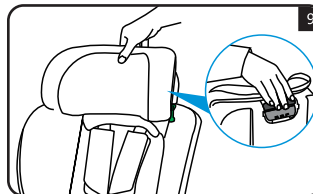

First loosen the harness. Squeezing headrest height adjuster at the same time slide headrest to shoulder height in accordance with the height of the child. (fig.9)

4.4 Adjusting recline positions

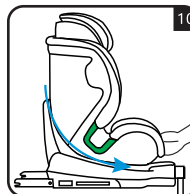

Seat has five recline positions.

For rearward facing, only use most reclined position. For forward facing, can use all five positions. Except most upright position, other positions may not fit in all approved vehicles.

Pull Recline lever at the same time incline seat to intend position.(fig.10)

4. PREPARATORY WORKS

4.5 Adjusting anti-rebound bar

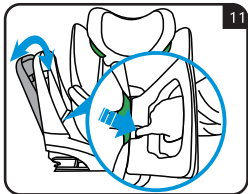

The anti-rebound bar has two positions reclined and upright, Forward facing only use upright position. Rotating child safety seat lateral facing. Pull up anti-rebound bar button then adjust the position of anti-rebound bar.

4.6 Rotating seat

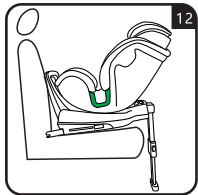

40-105cm (born to approx. 4 Years, ≤ 18 kg)

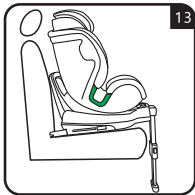

76-150cm (15 months to approx. 12 years)

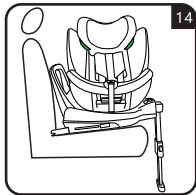

Lateral facing
For child sit convenience
Forbidden to use when driving

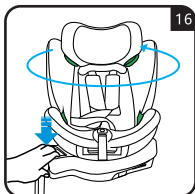
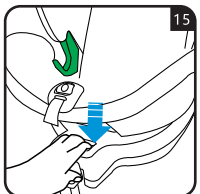

Pull rotation button at the same time rotate seat to intend direction.
(fig.15,16)

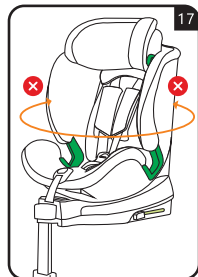

When seat rotates to intend direction, rotation button will bounce and make click sound. Then try to rotate seat to make sure seat is locked.
(fig.17)

4. PREPARATORY WORKS

4.7 Install the ISOFIX

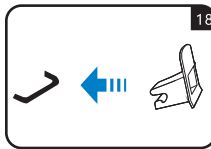

If your vehicle is not equipped with the ISOFIX insert guides as standard, clip the two insert guides which are included with the seat. with the cut-out facing upwards onto the two ISOFIX attachment points of your vehicle.

TIP: The ISOFIX attachment points are located between the surface and the backrest of the vehicle seat. Look for this symbol in your vehicle.



4.7.1 ISOFIX installation

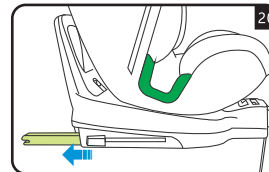
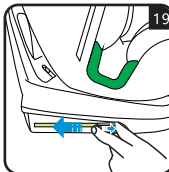

On both sides of the seat squeeze the ISOFIX button and pull out ISOFIX connectors in longest position. (fig.19,20)

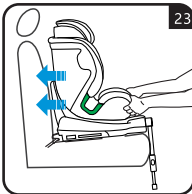
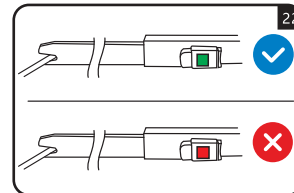
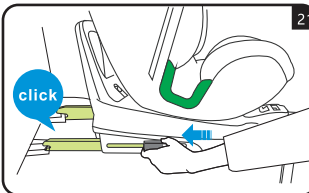

Slide the two ISOFIX connectors firmly into the insert guides until the ISOFIX connectors engage with a clicking noise on both sides. The ISOFIX button must turn green on both sides. (fig.21,22)

CAUTION! The ISOFIX connectors are only correctly engaged if both of the ISOFIX buttons are green

Push the child seat towards the backrest applying firm, even pressure on both sides. Shake the child safety seat to make sure it is safely attached and re-check the green safety buttons to make sure that both of them are completely green. (fig.23)

4. PREPARATORY WORKS

4.7.2 Remove ISOFIX

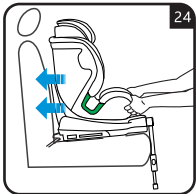

Push the child seat towards the backrest applying firm pressure.(fig.24)

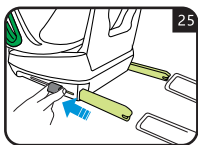

At the same time squeeze ISOFIX button and pull back ISOFIX connectors.(fig.25)

4.8 Install the support leg

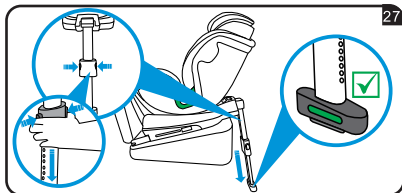
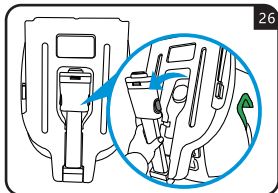

Pull the support leg away from the bottom of the seat until fully extended. Push both adjustment buttons and pull out the support leg until it rests firmly on the floor of the vehicle. Make sure the indicator on the support leg must turn green, the bottom of the seat does not lift up from the surface of the vehicle seat and two adjustment buttons must be engaged.

4.9 Remove and install harness

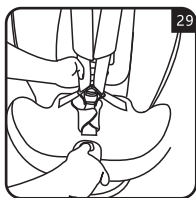

Loosen the 5-point harness on the child seat as far as possible. Then open the buckle.(fig.29)

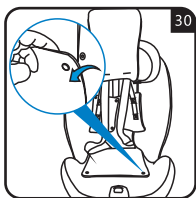

Loosen the press studs on the backrest and fold the upper half of the cover upwards and the lower half downwards.(fig.30)

4. PREPARATORY WORKS

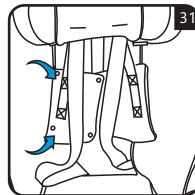

Open the two shoulder pads by the Velcro fasteners on the side. Push the Velcro strip of the two opened shoulder pads under the backrest cover and attach it to the fleece strip provided.(fig.31)

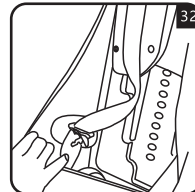

Insert the buckle tongues in the recess provided on the inside of the backrest.(fig.32)

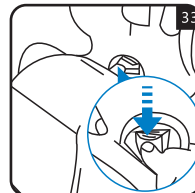

Open seat cover and fold the cover forwards, pull the harness buckle out of the cover.(fig.33)

Stow the harness buckle in the recess provided.(fig.34)

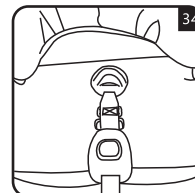

Close the two press studs and recovery seat cover.(fig.35)

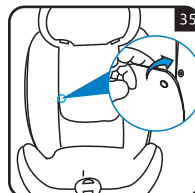

Re-fitting the harness: Simply follow the steps in the opposite order.

Make sure the belt is not twisted.

4. PREPARATORY WORKS/5. INSTALLATION

4.10 Install and remove side impact shield

This seat has been tested and approved to offer optimum side protection without side impact shield.

The side impact shield is optional for extra side protection, when used may not fit in all approved vehicles.

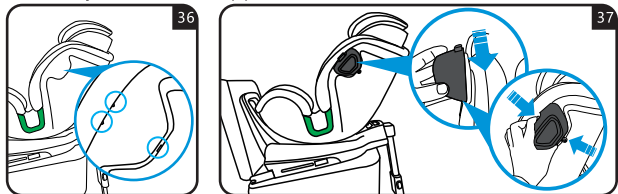

The side impact shield should install at the side which close to vehicle door.

Install: insert clip on side impact shield onto seat side wing where marked with two dents. Pull out the hook by press the button on side impact shield, and hooked into hole on seat side wing. **Remove:** press the button then unhook from seat side wing, slide out side impact shield from seat side wing.

5.1 Rearward facing 40-105cm (born to approx. 4 Years, ≤ 18 kg)

Notice: The infant cushion protects your child. It needs to be used up to size of 75 cm.

DO NOT place rear-facing child seat on front seat with active airbag, DEATH OR SERIOUS INJURY can occur.

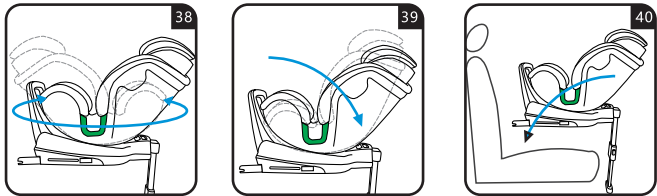

Pull away support leg from seat bottom, For more leg space adjust anti-rebound bar at incline position.

5. INSTALLATION

Rotate seat to rearward facing (see section 4.5, fig 38), adjust seat in most reclined position (see section 4.4, fig 39). Place seat in the direction facing opposite to the travel. (fig.40)

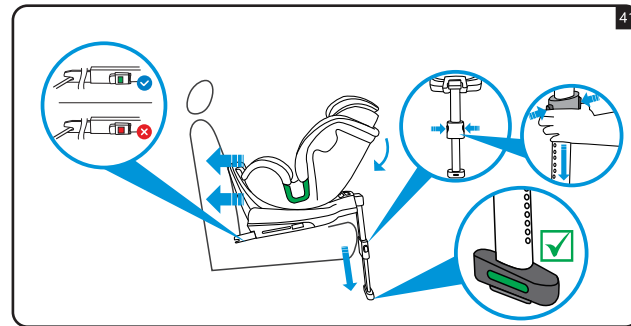

Install ISOFIX connectors (see section 4.7). Install support leg (see section 4.8) . (fig 41)

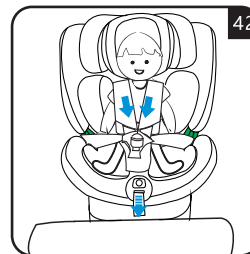

Have your child sit down in the child seat. Adjust headrest in proper height (see section 4.3), adjust harness and lock buckle (see section 4.1), and tighten harness. (see section 4. 2) (fig. 42)

5. INSTALLATION

5.2 Forward facing 76-105cm (15 months to approx. 4 years, ≤ 18 kg)

"IMPORTANT – DO NOT USE FORWARD FACING BEFORE THE CHILD'S AGE EXCEEDS 15 MONTHS".

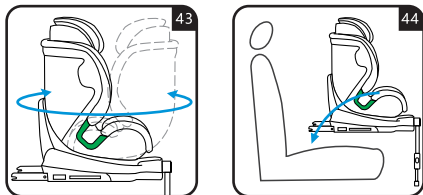

Pull away support leg from seat bottom, adjust anti-rebound bar at upright position. Rotate seat to forward facing (see section 4.5, fig 43). Place seat in the direction facing to the travel (fig 44). Install ISOFIX connectors (see section 4.7). Install support leg (see section 4.8). (fig 45)

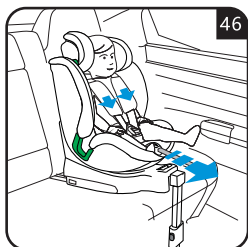
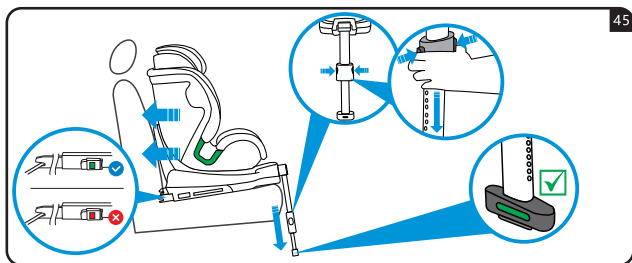

Have your child sit down in the child seat. Adjust headrest in proper height (see section 4.3), adjust harness and lock buckle (see section 4.1), and tighten harness. (see section 4.2) (fig. 46)

5. INSTALLATION

5.3 Forward facing 100-150cm (approx. 3 years to 12 years)

Remove harness when use for child stature 100-150cm.

See section 4.9

Make sure support leg stored at seat bottom, adjust anti-rebound bar at upright position.

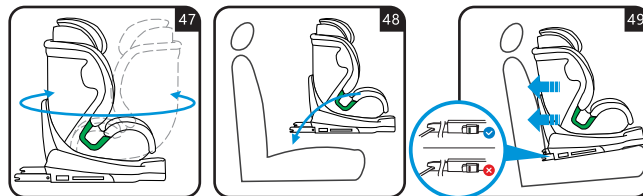

Rotate seat to forward facing (see section 4.5). Place seat in the direction facing to the travel. (fig.47,48)

There are two options to install:

- Only use vehicle 3 point belt or
- Use vehicle 3 point belt + Isofix connectors.

CAUTION! Both options do not use support leg.

Install ISOFIX connectors (see section 4.6) (fig.49)

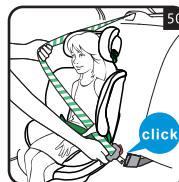

Have your child sit down in the child seat. Adjust headrest in proper height (see section 4.3). Pull out the vehicle seat belt and guide it in front of your child to the vehicle seat buckle. Engage the buckle tongue in the vehicle seat buckle. (fig.50)

Caution! The vehicle seat belt buckle must not be positioned in the lower belt guide

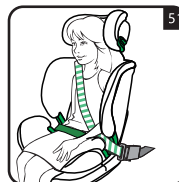

Place the diagonal seat belt section and lap belt section on the side of the vehicle seat belt buckle in the lower belt guide. (fig.51)



Place the lap belt section on the other side of the child seat in the lower belt guide. (fig.52)
Caution! The lap belt section must lie as low as possible over your child's hips on both sides

5. INSTALLATION/6. CLEANING

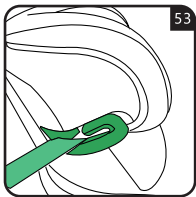

For child stature 100-150cm installation, this seat also can use vehicle belt only, it has been tested and homologated also. If you want only use vehicle belt installation, just skip the ISOFIX connector relative content.

Guide the diagonal seat belt section into the Belt holder and it is not twisted. (fig.53)

6. Cleaning

The cover can be removed and washed. Please observe the instructions on the washing label of the cover.

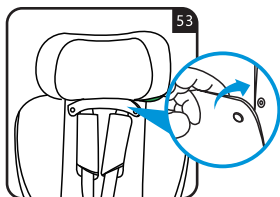

Loosen the press studs at the back of the headrest and remove the cover of headrest.

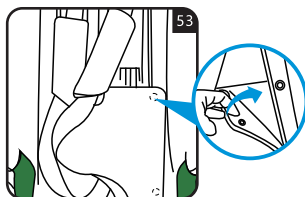

Loosen the press studs and unzip at the back of seat cover. Pull forward and remove seat cover.

Re-fitting Simply follow the steps in the opposite order.

7. CUSTOMER SERVICE

7.Customer service

We guarantees its products against any manufacturer defect for a period of 2 years, start from the day of purchase.

- 1.The warranty does not cover defects or failures caused by inappropriate use or non-compliance with the installation and maintenance safety standards described in the instruction guides provided with the products.
- 2.The warranty shall be automatically considered void if the article acquired has been repaired or if an attempt has been made to repair it by an individual that is not authorized by our company.

Manufacture: Ningbo Safetech Child Products Co., Ltd.
Address: Yinjiakeng Village, Shangtian Town, Fenghua District,
Ningbo City, Zhejiang Province, P.R.China
Telephone No.:0086 574 88880069
E-mail:qdygd@163.com