



Life is Precious.  
Be Safe.

# VinoFix

Group 0+,I,II,III (0-36kg)



**IMPORTANT READ INSTRUCTION MANUAL**  
before using this child restraint

This child restraint is approved to UN ECE regulation 44 , 04 series of amendments.

Please read all the instructions in this manual before installing and using the product.

### **Congratulations**

You have purchased a high quality, fully certified child safety child restraint.

This product is suitable for the use of children weighing UNDER 36kg (approximately 12 years old or under).

Carefully read this Instruction Manual and follow the installing steps because this is the ONLY way to protect your child from an accident, and to provide comfort to your child while using this product.

### **Keep this instruction manual for future reference.**

Make sure that your vehicle is equipped with 3-point retractor safety-belt.

Seat belts may be different in design and length according to maker, manufacturing date, and type of the vehicle. This child restraint is only suitable for use in the listed vehicles fitted with 3-point retractor safety-belts and approved to UN ECE regulation 16 . This child restraint is approved to and UN ECE regulation 44, 04 series of amendments.

For warranty information.

! Please keep the instruction manual in the storage compartment of the rear cover for future reference.

## Parts List

Make sure all parts are available before assembly. If any part is missing, please contact local retailer. No tools are required for assembly.

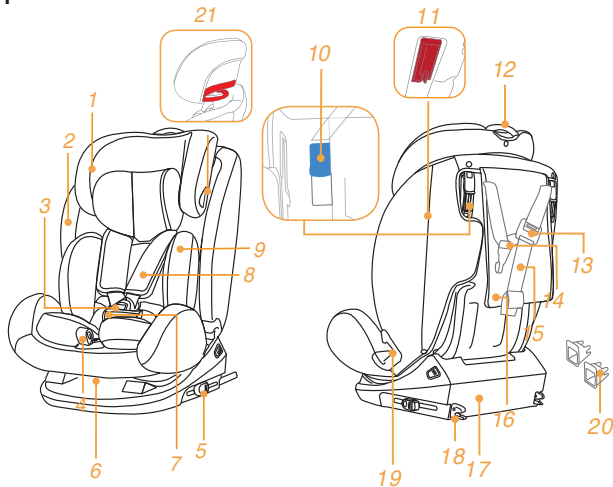

- |    |                                     |    |  |
|----|-------------------------------------|----|--|
| 1  | Head Support                        | 12 | Head Support Adjustment Lever          |
| 2  | Seat cover                          | 13 | Tether Strap Adjuster                  |
| 3  | Buckle                              | 14 | Tether Hook                            |
| 4  | Webbing Adjuster                    | 15 | Top Tether Strap                       |
| 5  | ISOFIX Attachments Releasing Button | 16 | Instruction Manual Storage Compartment |
| 6  | Recline Adjustment Handle           | 17 | Base                                   |
| 7  | Crotch Strap                        | 18 | ISOFIX Attachments Connector           |
| 8  | Shoulder Strap                      | 19 | Seat Belt Guiding                      |
| 9  | Infant Insert(0-9kg)                | 20 | ISOFIX Attachments Guides              |
| 10 | Rear-facing Lock-off                | 21 | Seat Belt Guiding Gr2+3(15-36kg)       |
| 11 | Group 1 Lock-off Device             |    |  |

Soft goods include Head Support, Seat Pad, Shoulder Strap, Crotch Strap and Infant Insert. Please make sure there are no missing parts. Please contact the retailer if anything is missing.

## GENERAL SAFETY NOTES

This child restraint is designed ONLY for child weighing under 36kg (approximately 12 years old or under).

! Any straps holding the restraint to the vehicle should be tight, that any straps restraining the child should be adjusted to the child's body, and that straps should not be twisted.

! When use this child restraint in baby or toddler mode, the safety belt must be used correctly, and ensure that any lap strap is worn low down, so that the pelvis is firmly engaged.

! The child restraint should be changed when it has been subject to violent stresses in an accident. An accident can cause damage to the child restraint that you cannot see.

! Concern the danger of making any alterations or additions to the device without the approval of the Type Approval Authority, and a danger of not following closely the installation instructions provided by the child restraint manufacturer.

! Please keep this child restraint away from sunlight, otherwise it may be too hot for the child's skin.

! Child is not left in the child restraint system unattended.

! Any luggage or other objects liable to cause injuries in the event of a collision shall be properly secured.

! The child restraint shall not be used without the soft goods.

! The soft goods should not be replaced with any other than the one recommended by the manufacturer, because the soft goods constitutes an integral part of the restraint performance.

! DO NOT use any load bearing contact points other than those described in the instructions and marked in the child restraint.

! NO child restraint can guarantee full protection from injury in an accident. However, proper use of this child restraint will reduce the risk of serious injury or death to your child.

! DO NOT use forward facing mode before the child's weight exceeds 9kg.



## GENERAL SAFETY NOTES

! DO NOT use or install this child restraint until you read and understand the instructions in this manual and in your vehicle owner's manual.

! DO NOT use this child restraint if it has damaged or missing parts.

! DO NOT have your child in unfitted clothes when use this child restraint in baby or toddler mode, because this may prevent your child from being properly and securely fastened by the shoulder harnesses and the harnesses between thighs.

! DO NOT leave this child restraint unbelted or unsecured in your vehicle because unsecured child restraint can be thrown around and may injure occupants in a sharp turn, sudden stop, or collision. Remove it if not in regular use.

! DO NOT place the child restraint in seating positions where an active frontal airbag is installed if your child is still in rear facing mode.

! NEVER use a second-hand child restraint or a child restraint whose history you do not know because they may have structural damage that endangers your child's safety.

! NEVER use ropes or any other substitutes in place of seat belts in case of injuries from restraint.

! DO NOT use this child restraint as a regular chair as it tends to fall down and injure the child.

! DO NOT put anything other than the recommended inner cushions in this child restraint.

! DO NOT carry this child restraint with a child in it.

! DO NOT allow the child restraint harness or buckles to become trapped or caught in the vehicle seat or door.

! To avoid suffocation, remove plastic bag and packaging materials before using this product. The plastic bag and packaging materials should then be kept away from babies and children.

! Remove this child restraint from the vehicle seat when it is not in use for a long period of time.

! Consult the distributor for issues concerning maintenance, repair and part replacement.

! Frequently check the ISOFIX attachments guides for dirt and clean them if necessary. Reliability can be effected by ingress of dirt, dust, food particles etc.



## WARNING

DO NOT install this child restraint under the following conditions:

1. Vehicle seats with 2-point safety belts.
2. Vehicle seats facing sideward or rearward with respect to the running direction of the vehicle.
3. Vehicle seats unstable during installation.

### Emergency

In case of emergency or accidents, it is most important to have your child taken care of with first aid and medical treatment immediately.

### Product Information

**Read all the instructions in this manual before using this product. If in doubt, consult either the child restraint manufacturer or the retailer.**

**For Installation with 3-point-belt or with ISOFIX (ISOFIX attachments and top tether)**

#### Notice

1. This is an ISOFIX CHILD RESTRAINT SYSTEM. It is approved to Regulation No. 44, 04 series of amendments for general use in vehicles fitted with ISOFIX anchorages systems.
2. It will fit vehicles with positions approved as ISOFIX positions (as detailed in the vehicle handbook), depending on the category of the child seat and of the fixture.
3. The mass group and the ISOFIX size class for which this device is intended is: Group I (9-18kg) B1

## Notice

1. This is a installed 'Universal' child restraint. It is approved to UN ECE regulation 44, 04 series of amendments, for general use in vehicles and it will fit most, but not all, car seats.
2. A correct fit is likely if the vehicle manufacturer has declared in the vehicle handbook that the vehicle is capable of accepting a "Universal" child restraint for this age group.
3. This child restraint has been classified as "Universal" under more stringent conditions than those which applied to earlier designs which do not carry this notice.
4. If in doubt, consult either the child restraint manufacturer or the retailer.

## Notice

This child restraint is classified for Semi-universal use and is suitable for fixing into the seat positions of the following cars:

<u>CAR</u>	<u>FRONT</u>	<u>REAR</u>
<u>all the vehicles with</u>		<u>Centre</u>
<u>lanchroages</u>	No	Yes No

1. Only suitable if the approved vehicles are fitted with 3 point approved to UN/ECE Regulation No. 16 or other equivalent standards.
2. DO NOT place the child restraint in seating positions where an active frontal airbag is installed if your child is still in rear facing mode.
3. ! DO NOT use forward facing mode before the child's weight exceeds 9kg.



## Concerns on Installation

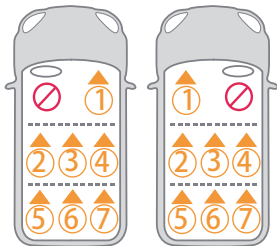
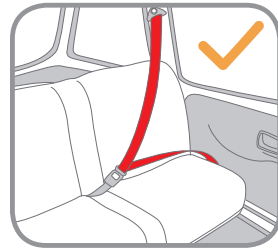
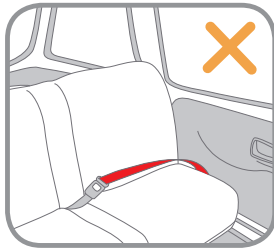
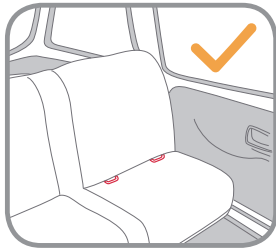



This child seat offers a variety of installation options. The following table indicates the types of installation for respective groups:

<b>Gr</b>	<b>Weight</b>	<b>Installation Method</b>	<b>Child Installation Method</b>	<b>Direction of installation</b>
0+1	0-18Kg	Vehicle 3 Points Belt	5 Points Harness	rearward facing
1	9-18Kg	Isofix Attachment+ Top Teather	5 Points Harness	forward facing
1	9-18Kg	Vehicle 3 Points Belt	5 Points Harness	forward facing
2+3	15-36Kg	Fix + Vehicle 3 Points Belt	Vehicle 3 Points Belt	forward facing
2+3	15-36Kg	Vehicle 3 Points Belt	Vehicle 3 Points Belt	forward facing

## Recline Adjustment

Press the recline adjustment handle, and adjust the child restraint to the proper position.

The recline angles are shown as There is 3 recline angles for rear facing baby mode, it is marked as blue triangle.



There are four recline angles "1—4" for toddler mode Angle indication : with top and bottom triangle aligned.

There is one recline angle for 1 junior mode, it is marked as " 1" red triangle.

Make sure that vehicle seat belt will be tight when adjusted in reclining position and vice versa if seat was already buckled up properly previously.

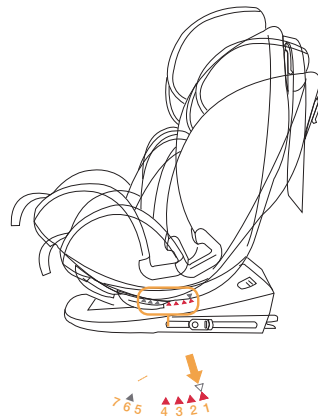

## Height Adjustment for Head Support and Shoulder Harnesses

Please adjust the head support and shoulder harnesses to proper height according to the child's height.

! When used in baby mode, the shoulder harness height must be even with child's shoulders.

! When used in toddler mode, the shoulder harness height must be even with child's shoulders.

! When used in junior mode, the shoulder belt guides must be even with child's shoulders.

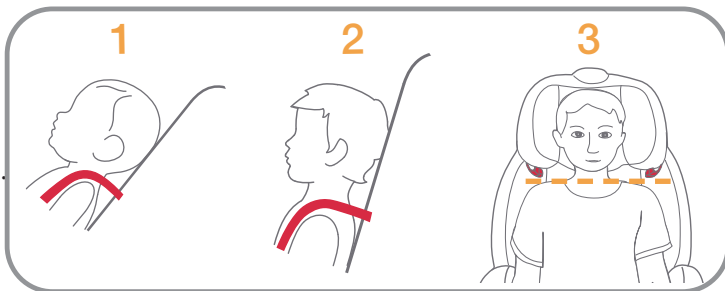

If the shoulder harnesses are not at proper height, the child may be thrown from the child restraint when there is an accident.

Squeeze the head support adjustment lever, meanwhile pull up or push down the head support until it snaps into one of the 11 positions.

The head support positions are shown as

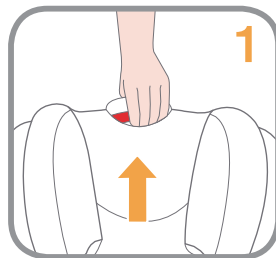

## Baby mode

(Rearward Facing Mode/for Child under 18kg)

! Please install the child restraint on the rear vehicle seat . and then put the child in the child restraint.

### Installation for Baby Mode

- ! Please adjust the child restraint to proper angle (3 positions for babymode).  
Angle indication: With top triangle and blue triangle aligned.
- ! Make sure the shoulder harness is adjusted to proper height before installing this child restraint.
- ! When installing and adjusting the safety belts, make sure that both the shoulder belt and the waist belt are not twisted and will not stop the safety belts from functioning properly.

1. Pass the waist belt over lap belt guidings, and then engage the vehicle buckle tongue into the buckle.

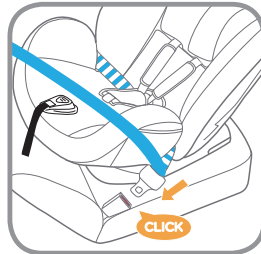
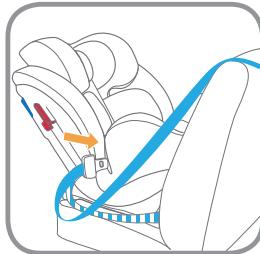

2. Fasten the shoulder belt in the two shoulder-belt slots at the back of the child restraint.  
! Shoulder belt must pass through the Lock-off.  
! Ensure the belt lock off cover is completely closed when not in use to prevent injury, or damage to vehicle upholstery.

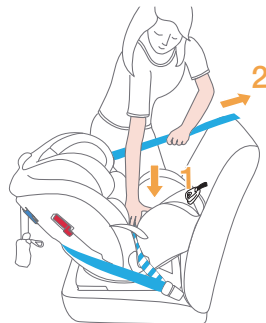
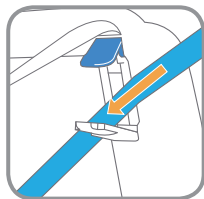
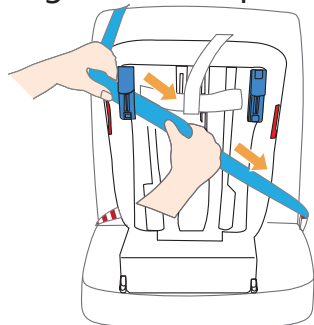

3. While pressing the child restraint, pull the belts to fasten the child restraint tightly and securely.  
! The child restraint can not be used if the vehicle safety belt buckle (female buckle end) is too long to anchor the child restraint securely.



- ! Please check by moving the child restraint back and forth.

## Correctly assembled vehicle belt is shown as

1. Waist belt passes through the lap belt guidings.
2. Shoulder belt must pass through the shoulder-belt slots.
3. The vehicle buckle tongue is engaged with the buckle correctly.

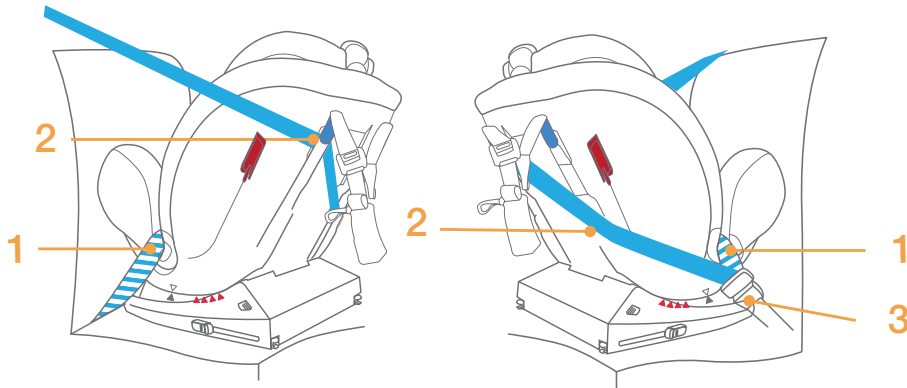

# Securing your Child in the Child Restraint Use Infant Insert

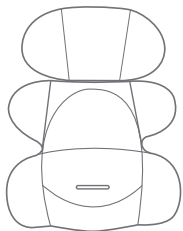

We recommend using the full Infant insert while the baby is 0-9kg or until they outgrow the insert. The infant insert increases side impact protection.

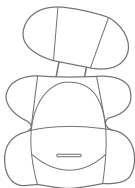

Detach the snaps on the head support to remove the head portion of the insert.



Remove the head support portion of the infant insert when the child's head no longer fits comfortably.

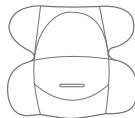

Remove the body portion of the infant insert when the infant's shoulders no longer fit comfortably.

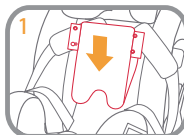
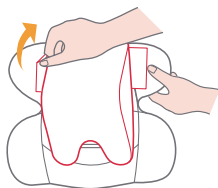

Remove the infant insert cushion by detaching the snaps to allow more space when the infant does not fit comfortably.

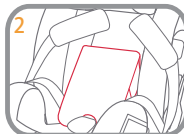

The cushion can be used separately without being attached to the insert to bolster the infant's back for more comfort.

1. While pressing the harness adjustment button, pull completely the two shoulder harnesses of the child restraint.

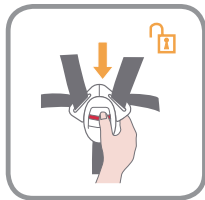

2. Press the red button to disengage the buckle.

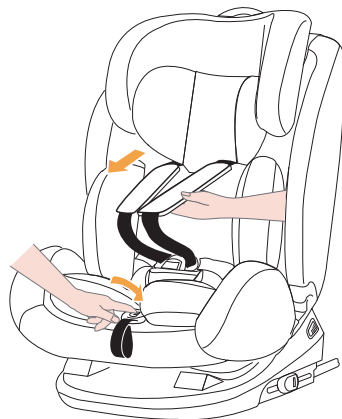

3. Place the child in the child restraint and pass both arms through the harnesses.

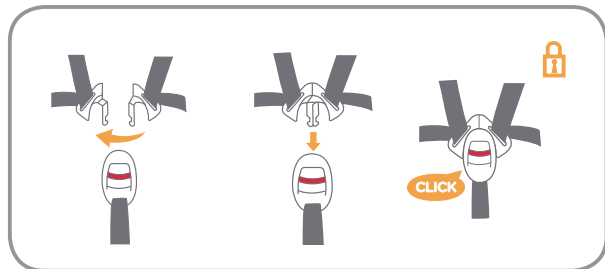

4. Engage the buckle.



5. Pull down the adjustment webbing and adjust it to the proper length to make sure your child is snugly secured.
- ! After the child is seated, recheck whether the shoulder harnesses are at the proper height.
  - ! Make sure the space between the child and the shoulder harness is about the thickness of one hand.



## **Toddler Mode**

**(Forward Facing Mode/ for Child between 9-18kg)**

! Please install the child restraint on the vehicle seat, and then put the child in the child restraint.

### **Installation for Toddler Mode**

! Please adjust the child restraint to proper angle (4 positions for toddler mode).

Angle indication: With top triangle and red triangle aligned.

! Please adjust the shoulder harnesses to proper height before installing the child restraint.

! When installing and adjusting the safety belts, make sure that both the shoulder belt and the waist belt are not twisted and will not keep the safety belts from being properly positioned.

## For installation with 3-point-belt

1. Thread the safety belt through two seat belt back slots at the back of the child restraint.

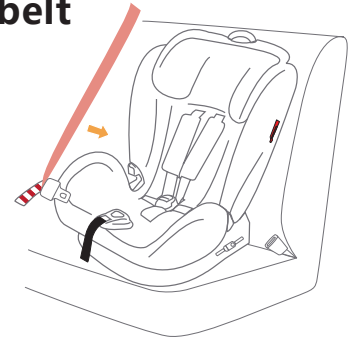

2. Buckle the safety belt.

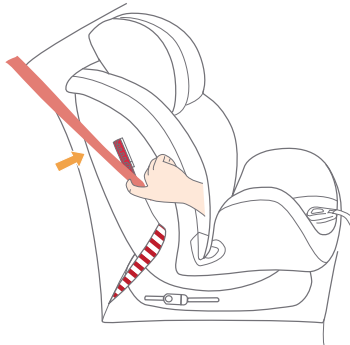

3. Open the lock-off device and insert the safety belt through it.

4. While pressing the child restraint, pull the belts to fasten the child restraint tightly and securely.

- ! The child restraint can not be used if the vehicle safety belt buckle (female buckle end) is too long to anchor the child restraint securely.
- ! Please check by moving the child restraint back and forth.

### The assembled safety belt is shown

1. Shoulder belt passes through Lock-off Device.
2. Waist belt passes through the seat belt back slots.
3. The vehicle buckle tongue is engaged with the buckle correctly.

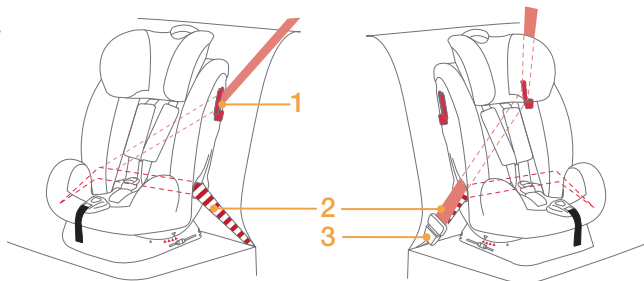

## For installation with ISOFIX (ISOFIX attachments and top tether)

1. Fit the ISOFIX attachments guides with the ISOFIX attachments anchor points. The ISOFIX attachments guides can protect the surface of the vehicle seat from being torn. They can also guide the ISOFIX attachments connectors.

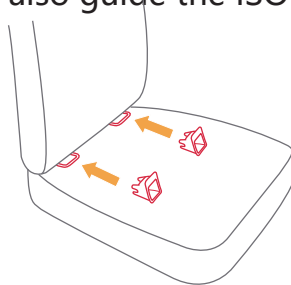

2. Extend the ISOFIX attachments connectors by depressing on the release button whilst pulling on the connector.

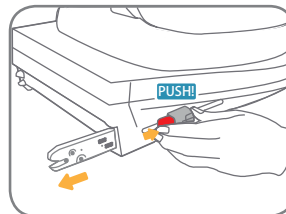
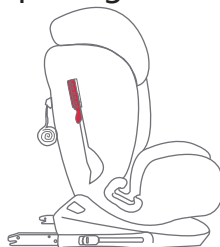

- ! Make sure that both ISOFIX attachments connectors are securely attached to their ISOFIX attachments anchor points. The colors of the indicators on both ISOFIX attachments connectors should be completely green.
- ! The ISOFIX attachments connectors must be attached and locked onto the ISOFIX attachments anchor points.
- ! Check to make sure the child restraint is securely installed by pulling on the both ISOFIX attachments connectors.
- ! Select the desired recline position before moving back against the vehicle seat, as once the top tether is attached and tensioned, the recline angle will not be able to change without adjustment to the top tether.

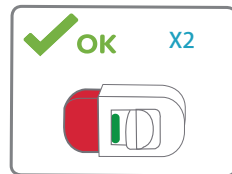
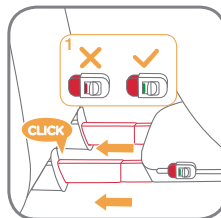
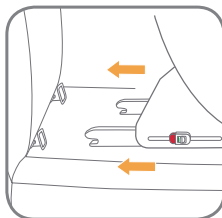
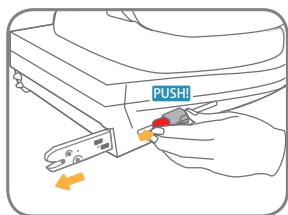

3. Press the ISOFIX attachments release button and push the child restraint back against the vehicle seat until tight.

4. To extend Top Tether for use, press button on Tether Adjuster and pull to lengthen.



5. Connect the tether hook securely to the anchorage fitting.

! USE Top Tether for toddler mode installation if vehicle is equipped with a Tether anchorage fitting and vehicle requirements are met (see vehicle owner's manual).

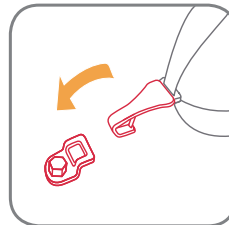

6. Correctly assembled ISOFIX (ISOFIX attachments and top tether) is shown

! Make sure that tether hook are securely attached to the anchorage fitting. The colors of the indicators on tether strap adjuster should be completely green.

! If recline angle is adjusted, check the tension on the top tether, or loosen to adjust angle then re-tension.

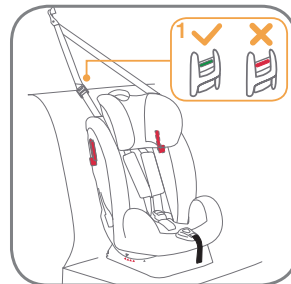

! To remove the ISOFIX

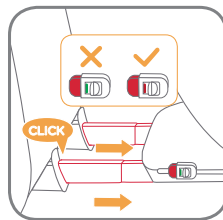
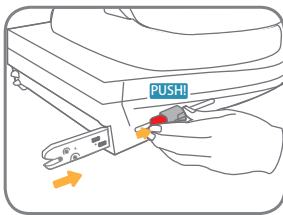
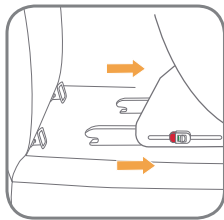

! attachments connectors, press the secondary lock button first and then the button before pull on the ISOFIX attachments connectors. The ISOFIX attachments is folded completely.

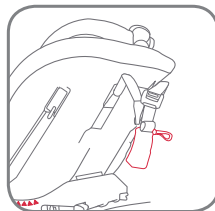

! When not in use, Top Tether MUST be properly stored. To make sure the top tether is properly stored away, remove any slack in strap to avoid the top tether swinging around when the vehicle is in progress.

! When the pocket is not used, please store it properly.



## Securing your Child in the Child Restraint

! When installing the child restraint in the toddler mode, do not use the infant insert.

1. While pressing the harness adjustment button, pull completely the two shoulder harnesses of the child restraint.
2. Press the red button to disengage the buckle.
3. Place the child in the child restraint and engage the buckle.

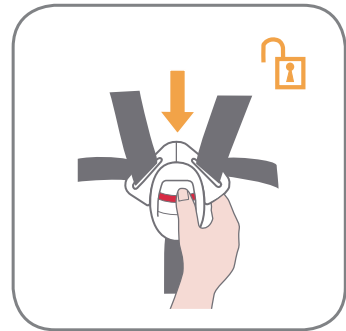
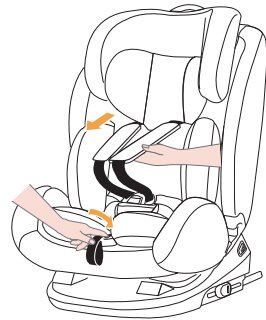

4. Pull down the adjustment webbing and adjust it to the proper length so that your child is snugly secured.

! After the child is seated, recheck whether the shoulder harnesses are at proper height.

! Make sure the space between the child and the shoulder harness is about the thickness of one hand.



## Junior Mode

**(Forward Facing Mode / for Child 15–36kg)**

### i. Installation for Junior Mode

! Just use the vehicle seat belt when installing the child restraint in the junior mode, do not use the infant insert or 5 point harness, please store the shoulder harnesses, buckle and buckle tongues in respective storage compartments.

! Please adjust the shoulder harnesses to proper length before store the shoulder harnesses and buckle in their storage compartments.

! Please adjust the child restraint to proper angle Angle indication: With top triangle and red triangle aligned.

! When installing and adjusting the safety belts, make sure that both the shoulder belt and the waist belt are not twisted and will not keep the safety belts from being properly positioned.

1. Press the red button to disengage the buckle.
  2. Remove the infant insert and crotch pad.
- ! When installing the child restraint in the Junior mode, do not use the infant insert.

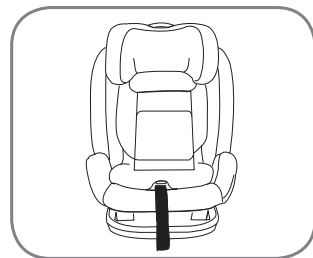
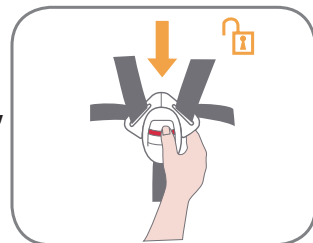
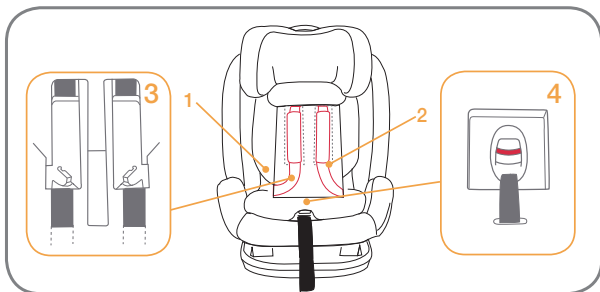

3. Detach the snaps.
4. Lift the upper flap upward and pull the lower flap forward, and then store the shoulder harnesses and buckle in their storage compartments.
5. Pull the buckle to the back of the seat pad, and then store the buckle and buckle tongues in respective storage compartments.
6. Do reattach the snaps to recover the seat pad. The reassembled seat pad is shown.

## Securing your Child in the Child Restraint

### For installation with 3-point-belt

1. Place the child in the child restraint and check whether the shoulder belt guides are at proper height.
2. Position shoulder belt through shoulder belt guide, Fasten buckle and pull the vehicle belt to tighten.

- ! Shoulder belt must pass through shoulder belt guide.
- ! Waist belt must pass through lap belt guidings.
- ! The vehicle waist belt must cross through the middle of the crotch belt cover and then attach the loop and hook fasteners.
- ! The child restraint can not be used if the vehicle safety belt buckle is too long to anchor the child restraint securely.
- ! Do not use shoulder belt loose or positioned under arm.
- ! Do not use shoulder belt behind child' s back.
- ! Do not allow child to slide down in the child restraint in case of strangulation.

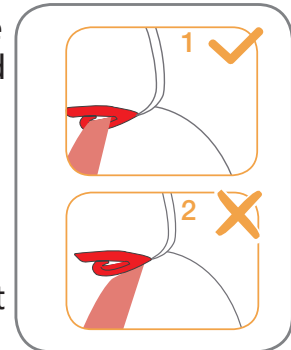

## For installation with 3-point-belt and FIX attachments

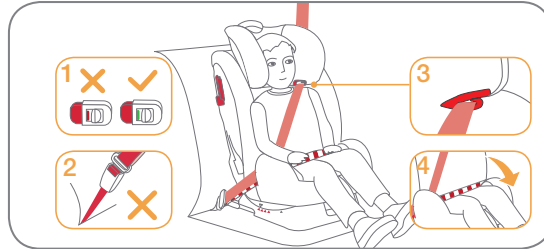

1. Installation with FIX attachments is show .
  2. Place the child in the child restraint and check whether the shoulder belt guides are at proper height.
  3. Installation with 3-point-belt is show.
  4. Correctly assembled 3-point-belt and FIX attachments is show.
- ! Make sure that both FIX attachments connectors are securely attached to their FIX attachments anchor points. The colors of the indicators on both FIX attachments connectors should be completely green.
  - ! Check to make sure the child restraint is securely installed by pulling on the both FIX attachments connectors.
    - ! Shoulder belt must pass through shoulder belt guide.
  - ! The vehicle waist belt must cross through the middle of the crotch belt cover and then attach the loop and hook fasteners.
    - ! Waist belt must pass through lap belt guidings.
  - ! The child restraint can not be used if the vehicle safety belt buckle is too long to anchor the child restraint securely.
    - Do not use shoulder belt loose or positioned under arm.
    - ! Do not use shoulder belt behind child' s back.
  - ! Do not allow child to slide down in the child restraint in case of strangulation.

## Detach Soft Goods

1. Press the red button to disengage the buckle.
  2. Remove the infant insert and crotch strap.
  3. Detach the elastic on the head support, and then remove the head support.
  4. Detach the snaps on the seat pad, pull the buckle to the back of seat pad, and then remove the seat pad.
- ! To assemble soft goods, reverse the steps above.



## Maintenance

- ! After removing the foam of infant insert . please store it somewhere that the child can not access it.
- ! Please wash the soft goods with cold water under 30°C.
- ! Do not iron the soft goods.
- ! Do not bleach or dry clean the soft goods.
- ! Do not use undiluted neutral detergent . gasoline or other organic solvent to wash the child restraint. It may cause damage to the child restraint.
- ! Do not twist the soft goods to dry with great force. It may leave the soft goods with wrinkles.
- ! Please hang dry the soft goods in the shade.
- ! Please remove the child restraint from the vehicle seat if not in use for a long period of time. Put the child restraint in the shade and somewhere your child can not access it.





Life is Precious.  
Be Safe.

Koopers Distribution Sdn Bhd

☎ 03-78324338

🌐 [www.koopers.co](http://www.koopers.co)

📘 [www.facebook.com/koopersmalaysia](https://www.facebook.com/koopersmalaysia)

✉ [sales@koopers.co](mailto:sales@koopers.co)

📍 18-1, Jalan Bulan U5/BM, Section U5, Bandar Pinggiran Subang,  
40150 Shah Alam, Selangor  
Malaysia