



the journey will never be the same

Koopers Distribution Sdn Bhd

☎ 03-78324338

🌐 [www.koopers.co](http://www.koopers.co)

📘 [www.facebook.com/koopersdistribution](https://www.facebook.com/koopersdistribution)

✉ [sales@koopers.co](mailto:sales@koopers.co)

📍 18-1, Jalan Bulan U5/BM, Section U5, Bandar Pinggiran Subang,  
40150 Shah Alam, Selangor  
Malaysia



## Boston

Group

0+ 1 2

Applicable to  
0-25KG



---

# User Manual

# Thank you for trust to our company and products!

Please read user manual carefully before installing.

## 1.ISOFIX SEMI-UNIVERSAL 0+ (0-13kg):ISOFIX+TOP TETHER+HARNESS



### NOTICE

- 1.This is an ISOFIX CHILD RESTRAINT SYSTEM. It is approved to Regulation No. 44, 04 series of amendments for general use in vehicles fitted with ISOFIX anchorages systems.
- 2.It will fit vehicles with positions approved as ISOFIX positions (as detailed in the vehicle handbook), depending on the category of the child seat and of the fixture.
- 3.The mass group and the ISOFIX size class for which this device is intended is: 0+group, 0-13kg, ISOFIX D.

This Child restraint is classified for "(Semi-Universal)" use and is suitable for fixing into the seat positions of the following cars :

CAR	FRONT	REAR	
(Apply to all vehicles with ISOFIX anchorages)	Outer	Outer	Centre
	No	Yes	No

Seat positions in other cars may also be suitable to accept this child restraint. If in doubt, consult either the child restraint manufacturer or the retailer.

## 2.ISOFIX UNIVERSAL I (9-18kg):ISOFIX+TOP TETHER+HARNESS



### NOTICE

- 1.This is an ISOFIX CHILD RESTRAINT SYSTEM. It is approved to Regulation No. 44, 04 series of amendments for general use in vehicles fitted with ISOFIX anchorages systems.
- 2.It will fit vehicles with positions approved as ISOFIX positions (as detailed in the vehicle handbook), depending on the category of the child seat and of the fixture.
- 3.The mass group and the ISOFIX size class for which this device is intended is: I group, 9-18kg, ISOFIX B1.

### NOTICE

1. This is a "Universal" child restraint. It is approved to Regulation No. 44, 04 series of amendments, for general use in vehicles and it will fit most, but not all, car seats.
2. A correct fit is likely if the vehicle manufacturer has declared in the vehicle handbook that the vehicle is capable of accepting a "Universal" child restraint for this age group.
3. This child restraint has been classified as "Universal" under more stringent conditions than those which applied to earlier designs which do not carry this notice.
4. If in doubt, consult either the child restraint manufacturer or the retailer.

⚠ Forbid putting children's safety seat in the front row seat with airbag. It might cause serious injury, even death.

⚠ Important – Do not use forward facing installation when body weight is less 9kg (Refer to user manual).

## 3.UNIVERSAL II (15-25kg):3-POINT BELT



### NOTICE

1. This is a "Universal" child restraint. It is approved to Regulation No. 44, 04 series of amendments, for general use in vehicles and it will fit most, but not all, car seats.
2. A correct fit is likely if the vehicle manufacturer has declared in the vehicle handbook that the vehicle is capable of accepting a "Universal" child restraint for this age group.
3. This child restraint has been classified as "Universal" under more stringent conditions than those which applied to earlier designs which do not carry this notice.
4. If in doubt, consult either the child restraint manufacturer or the retailer.

⚠ Only suitable for use in the listed vehicles fitted 3 point/with retractor safety-belts, approved to ECE Regulation No. 16 or GB14166.

## 4.SEMI-UNIVERSAL II (15-25kg): ISOFIT+3-POINT BELT



### NOTICE

Only suitable for use in the listed vehicles fitted 3 point/with retractor safety-belts, approved to ECE Regulation No. 16 or GB14166.

This Child restraint is classified for "(Semi-Universal)" use and is suitable for fixing into the seat positions of the following cars :

CAR	FRONT	REAR	
(Apply to all vehicles with ISOFIX anchorages)	Outer	Outer	Centre
	No	Yes	No

Seat positions in other cars may also be suitable to accept this child restraint. If in doubt, consult either the child restraint manufacturer or the retailer.

## WARNING

1. The steel components and plastic components of safety seat have to be fixed by referring to manual, which ensure safety seat not be stuck by car seats and car doors.  
Any straps holding the restraint to the vehicle should be tight, that any straps restraining the child should be adjusted to the child's body, and that straps should not be twisted.
3. Any lap strap is worn low down, so that the pelvis is firmly engaged, shall be stressed.
4. It can not be used when it has been subject to violent stresses in an accident.
5. It's dangerous to make any alterations or additions to the chair without the approval of the Type Approval Authority, and it's a danger of not following closely the installation instructions provided by the child restraint manufacturer.
6. The chair should be kept away from sunlight, otherwise it may be too hot for the child's skin.
7. Please do not leave your child in their child restraint system unattended.
8. Any luggage or other objects liable to cause injuries in the event of a collision shall be properly secured.
9. a: The child restraint shall not be used without the cover.  
b: The seat cover should not be replaced with any other than the one recommended by the manufacturer, because the cover constitutes an integral part of the restraint performance.
10. The instructions can be retained on the child restraint for its life period.
11. Do not use any load bearing contact points other than those described in the instructions and marked in the child restraint.
12. The rigid items and plastic parts of a child restraint shall be so located and installed that they are not liable, during everyday use of the vehicle, to become trapped by a movable seat or in a door of the vehicle.
13. Any luggage or other objects liable to cause injuries in the event of a collision shall be properly secured
14. Safe driving is the best way to protect children, and children's safety seats can protect children effectively but cannot completely eradicate the harms of car accidents.
15. Please be sure to use the right Group of the children's seats with appropriate methods of application, which refer to the instructions manual of child restraint system. Otherwise, there is potential risk to cause child injuries.
16. The child safety seat must not be positioned anywhere where it is in range of an airbag which is being deployed, otherwise, once accident happened, airbag can hurt your child.
17. If there is mutual interference between the adult safety-belt buckle and the main load bearing contact points on the restraint, it cannot be used. The user shall be advised to contact the child restraint manufacturer if in doubt about this point.
18. Don't use forward facing before the child's weight exceeds 9kg.
19. Rearward facing can not be installed in the position which is equipped with airbag.
20. Keep the instruction for future use.

## Table Of Contents

Know Your Car Seat (Front) .....	5
Know Your Car Seat (Opposite) .....	6
Know Your Car Seat (Seat body and base) .....	7
Selection Criteria for Baby Car Seat .....	8
Rearward Facing Placement .....	9
Forward Facing Placement .....	11
Group 0+: ISOFIX+TOP Tether +Harness Installation .....	13
Group I: ISOFIX+TOP Tether +Harness Installation .....	18
5-Point Harness Removal .....	23
Group II: Installation and Using method .....	25
Removing the Cover .....	28
Cleaning and Maintenance .....	29

## Know Your Car Seat (Front)

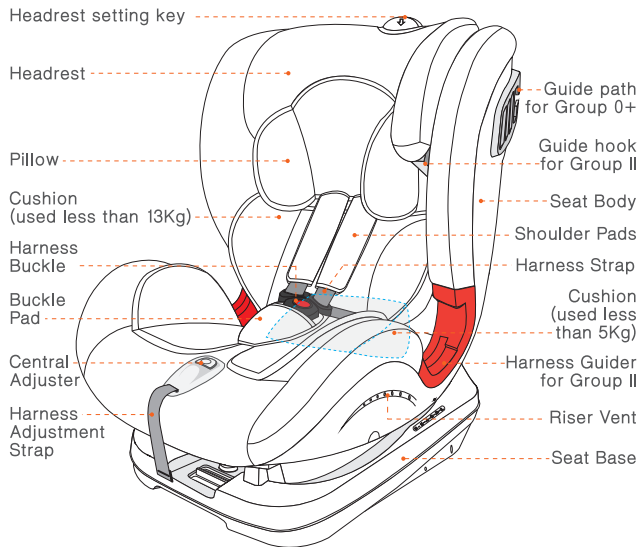

## Know Your Car Seat (Opposite)

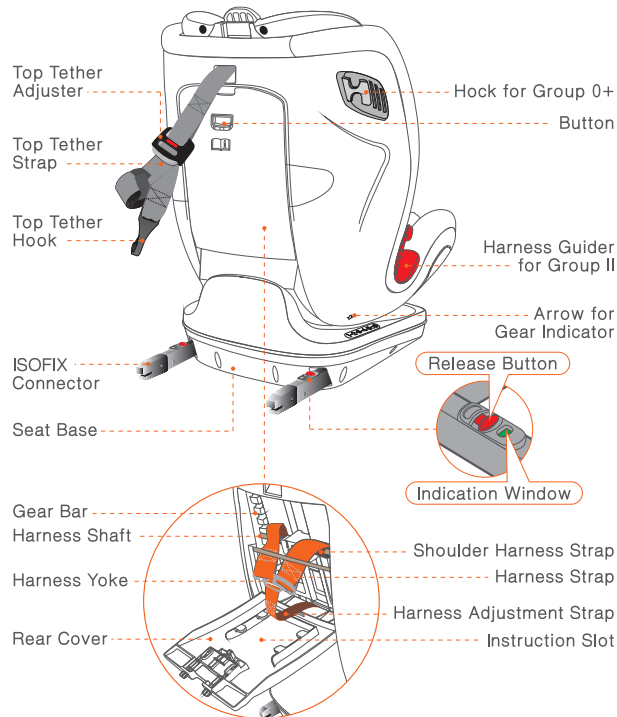

## Know Your Car Seat (Seat body and base)

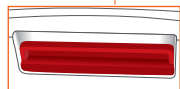
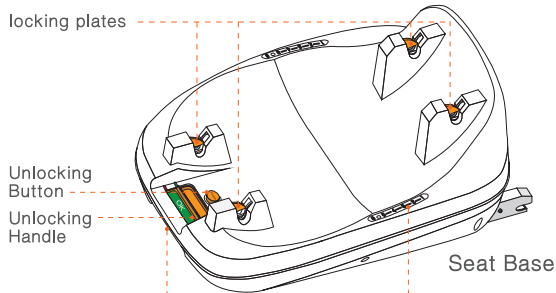
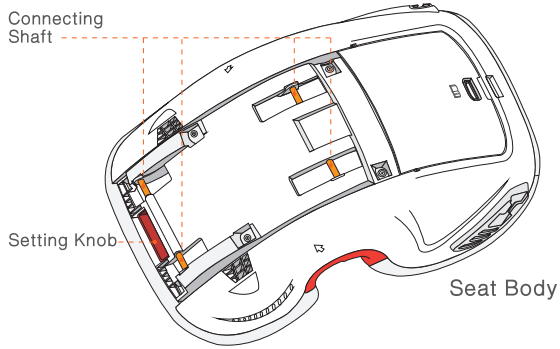

6 5 4 3 2 1

Gear Indicator for Setting Posture

## Selection Criteria for Baby Car Seat

- This type baby car seat is applied to Group0+//I and the requirement for weight is from 0 to 25kg. It is suitable for around 0 to 6 year-old children. The vehicle should have ISOFIX anchorages.
- Different installation methods should be applied to children in different group. Please follow the below standards to match the right group installation.
- Do not use any load bearing contact points other than those described in the instructions and marked in the child restraint system.
- Baby car seat for Group 0+ can not be installed in the position which is equipped with airbag.

Group	Body weight	Age	Children's restraining system	Installation method	Direction of Installation	Requirement for vehicles
0+	0-13kg	0-15 months	5-point harness	ISOFIX + top-tether	Rearward Facing	The vehicle equipped with ISOFIX anchorages.
I	9-18kg	9 months-4years old	5-point harness	ISOFIX + top-tether	Forward Facing	The vehicle equipped with ISOFIX anchorages.
II	15-25kg	4-6 years old	vehicle's 3-point seat belt	ISOFIX + vehicle's 3-point seat belt	Forward Facing	The vehicle equipped with ISOFIX anchorages, and cannot be used if the vehicle seat is equipped with only 2-point belt.
II	15-25kg	4-6 years old	vehicle's 3-point seat belt	vehicle's 3-point seat belt	Forward Facing	The vehicle equipped with 3-point belt, and cannot be used if the vehicle seat is equipped with only 2-point belt.

- ② Only can apply to the vehicle that has ISOFIX anchorages and 3-point safety belts.

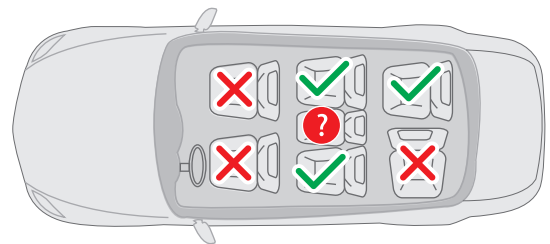

## Rearward Facing Placement

### Step 1: Open locking plates

- Before installation, open rearward sliding slot and forward sliding slot. Method: press unlocking button and pull unlocking handle. When you release locking button, there is red "X" in the unlocking handle and the mark of unlocking handle turns "close" to "open". Then, the seat base is on open status. As shown in the figure below.

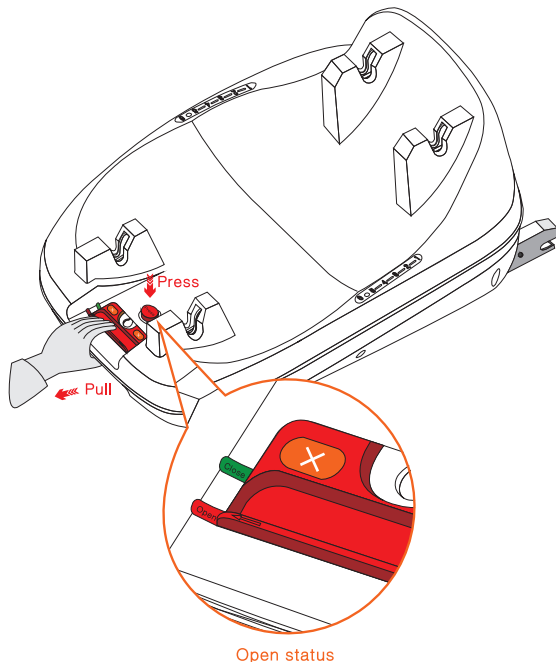

### Step 2: Fix seat body and base

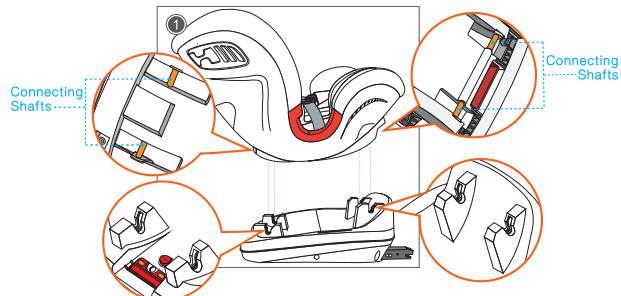

- Before combination, (Attention: in the forward facing placement, adjust the car seat to level 5) make four connecting shafts to aim rearward sliding slot and forward sliding slot. Then, put car seat into the base. As shown in figure ①.

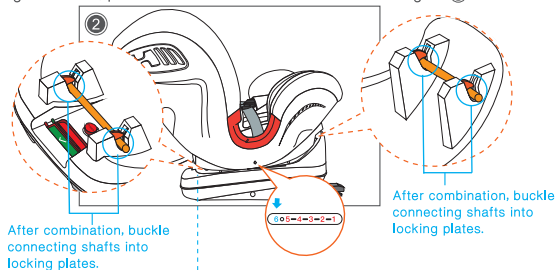

- After combination, press unlocking button and unlocking handle shows "✓". At the same time, the mark of unlocking handle turns "open" to "close". This car seat for Group 0+ only has one sitting postures and it is level 6. Set car seat to level 6 and wobble the seat to make sure whether the seat body and base are fixed well.

## Forward Facing Placement

### Step 1: Open locking plates

- Before installation, open rearward sliding slot and forward sliding slot. Method: press unlocking button and pull unlocking handle. When you release locking button, there is red "X" in the unlocking handle and the mark of unlocking handle turns "close" to "open". Then, the seat base is on open status. As shown in the figure below.

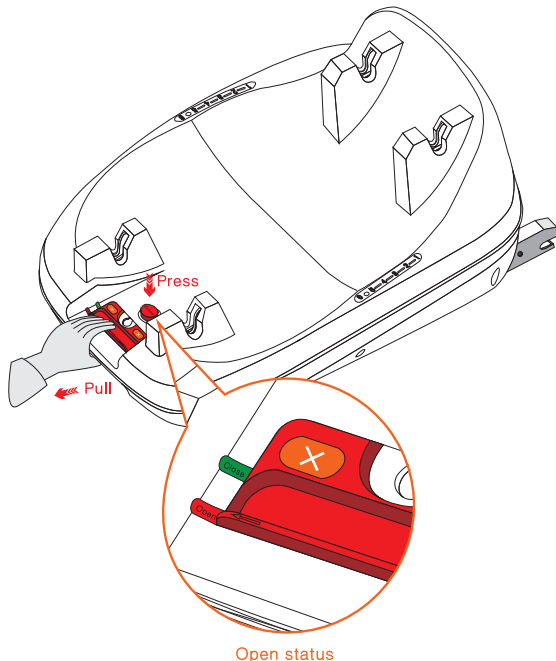

### Step 2: Fix seat body and base

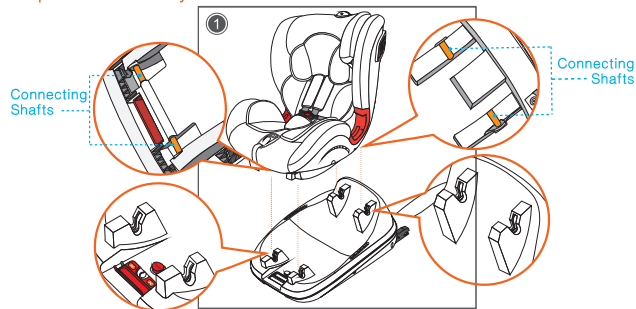

Before combination: make four connecting shafts to aim rearward sliding slot and forward sliding slot. Then, put car seat into the base. As shown in figure ①.

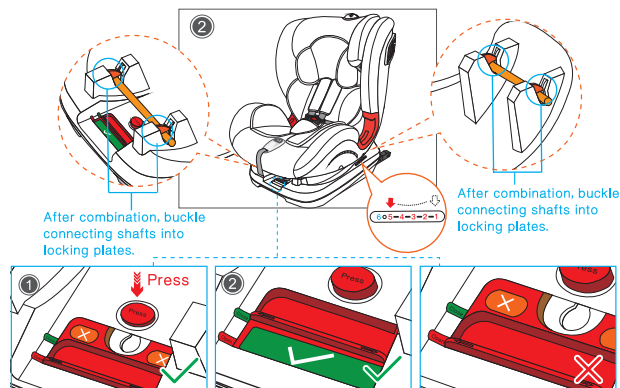

After combination: press unlocking button and unlocking handle shows "√". This car seat for Group I has five sitting postures and they are level 1/2/3/4/5. Before installation, please adjust car seat to a suitable sitting posture and wobble the seat to make sure whether the seat body and base are fixed well.



**Attention:**

1. Only suitable use in the listed vehicles fitted with ISOFIX anchorages.
2. The installation for Group 0+ is rearward facing and is applied to children from 0 to 13kg.
3. This car seat for Group 0+ only has one sitting postures and it is level 6.
4. Important - If your child's weight is below 9kg, you cannot make forward facing installation.
5. Baby car seat for Group 0+ can not be installed in the position which is equipped with airbag.

**1. ISOFIX Installation for Group 0+**

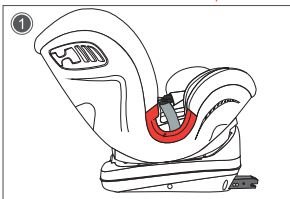

**Step 1:** As shown in figure ①, before installation, place car seat rearward facing, see user's manual page 9 to 10.

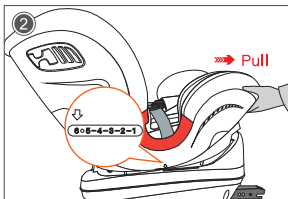

**Step 2:** As shown in figure ②, before installation, adjust the car seat to level 6.

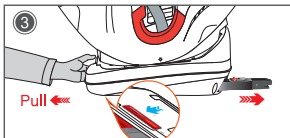

**Step 3:** As shown in figure ③, release ISOFIX connector. Pull ISOFIX setting key and ISOFIX connector will pop up automatically.

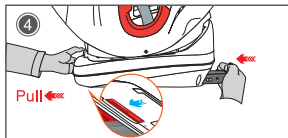

**Step 4:** As shown in figure ④, remove ISOFIX connectors. Pull ISOFIX setting key and push ISOFIX connectors into the base.

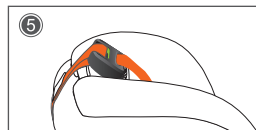

**Step 5:** As shown in figure ⑤, before installation ISOFIX connectors, pick up the top tether from rear cover and pull out some top tether strap. Then, put them in the headrest temporarily.

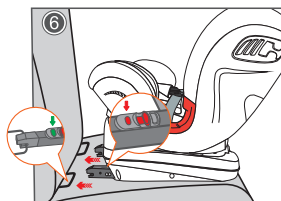

**Step 6:** As shown in figure ⑥, insert the two ISOFIX connectors firmly into the ISOFIX fixed point in the car seat with a "clicking" noise. In the meantime, ISOFIX indication window will become green. In order to release ISOFIX connectors, push the red button and the indication window will become red.

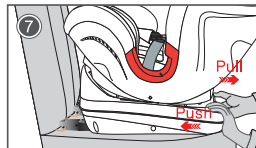

**Step 7:** As shown in figure ⑦, pull ISOFIX setting key and push the baby car seat to make it fix to the car seat.

**2. Top Tether Installation for Group 0+**

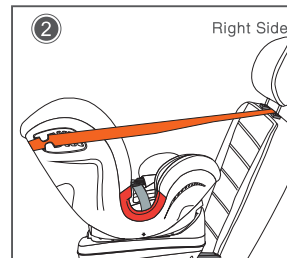
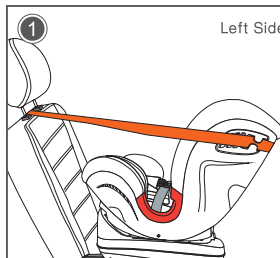

As shown as figure ① and ②, both of left guide path and right guide path for Group 0+ can be used in top tether installation.



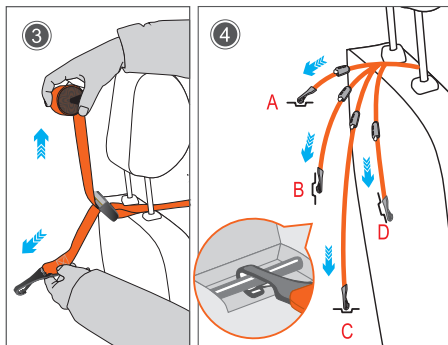

**Step 1:** Pull out the top tether to go through the guide path for Group 0+ and hook the user-ready anchorage behind and choose one in your favor (Refer to the User Manual from automaker). See figure ③ and ④.

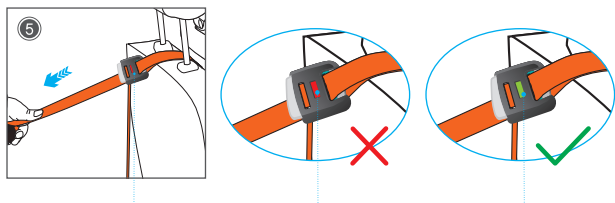

**Step 2:** Tighten the top tether until end of the strap release button show green. Meanwhile, wobble the car seat to check the top tether is tightened favorably and correctly. In order to release top tether, push the button to make top tether adjuster revolve some angle.

### 3. Harness Installation for Group 0+

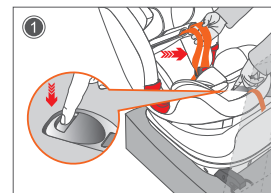

**Step 1:** Press the central adjuster and meanwhile, pull out the harness strap to release shoulder belt.

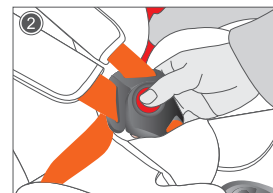

**Step 2:** Press the red button to open the harness buckle.

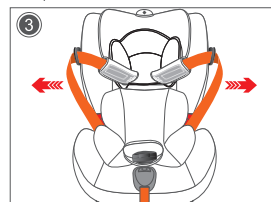

**Step 3:** Pull out both of the shoulder belt to both sides of the seat and insert buckle tongues into the fixed slots.

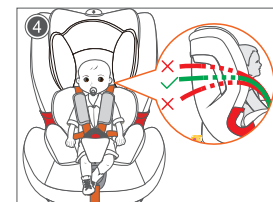

**Step 4:** Have your child sit on the seat to ensure the lap belt restrict the position of the pelvis. Please check the shoulder height, the shoulder belts are required to place a little bit higher level of your child's shoulders. Too high or too low may reduce the safety of the children's restraining system.

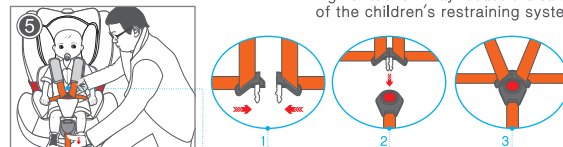

**Step 5:** Pull harness adjustment strap outward to fix child and avoid harness strap to constrict child too much. Adult palm can insert between harness strap and child's chest. Make sure the tightness is comfortable for your child and ensure the lap belt restrict the position of pelvis.

Methods to use harness buckle: guide the two buckle latches together and engage them before putting them into the harness buckle, this should make a click nose. The buckle latches will be released if you press the red button.

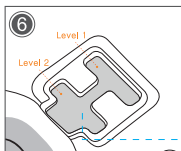

**Step 6:** In order to fit different somatotypes of children, there are two adjustable slots in the crotch parts. Before adjustment, loosen five-point safety belt and open buckle. Then twist the strap to go through a vertical slot and make sure buckle are fixed in the slot.

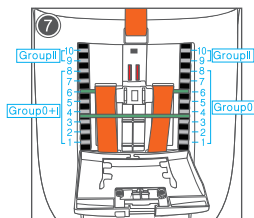
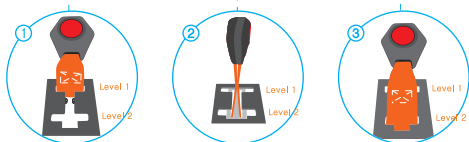

**Step 7:** Non-rethread harness system adjustable with headrest: according to different height of children, there are 4 levels to adjust the height of headrest and shoulder belt in Group 0+. Before adjustment, please loosen five-point safety belt. Attention: after sitting, adjust the headrest to the right position (PS: one or two fingers is the best distance from the bottom of headrest to child's shoulders).



One or two fingers is the best distance from the bottom of headrest to child's shoulders.

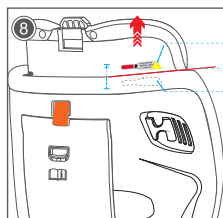

Higher than the base line for the side car seat body  
The base line for the side car seat body  
Lower than the base line for the side car seat body

**Step 8:** If the red line in the side of headrest exceeds the height of side car seat body, you should use Group II installation.

## Group I: ISOFIX+TOP Tether +Harness Installation



### Attention:

1. Only suitable use in the listed vehicles fitted with ISOFIX anchorages systems.
2. The installation for Group I is forward facing and is applied to children from 9 to 18kg.
3. This car seat for Group I has five sitting postures and they are level 1/2/3/4/5.

### 1. ISOFIX Installation for Group I



**Step 1:** As shown in figure ①, before installation, place car seat forward facing, see user's manual page 11 to 12.

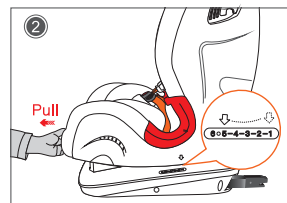

**Step 2:** As shown in figure ②, before installation, adjust the car seat to a suitable level.

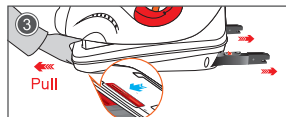

**Step 3:** As shown in figure ③, release ISOFIX connector. Pull ISOFIX setting key and ISOFIX connector will pop up automatically.

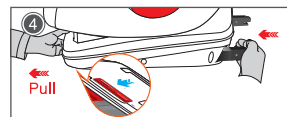

**Step 4:** As shown in figure ④, remove ISOFIX connectors. Pull ISOFIX setting key and push ISOFIX connectors into the base.

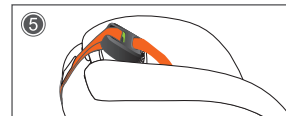

**Step 5:** As shown in figure ⑤, before installation ISOFIX connectors, pick up the top tether from rear cover and pull out some top tether strap. Then, put them in the headrest temporarily.

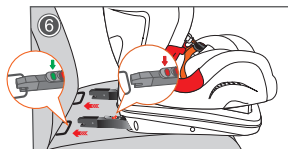

**Step 6:** As shown in figure ⑥, insert the two ISOFIX connectors firmly into the ISOFIX fixed point in the car seat with a "clicking" noise. In the meantime, ISOFIX indication window will become green. In order to release ISOFIX connectors, push the red button and the indication window will become red.

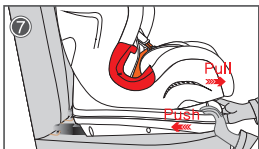

**Step 7:** As shown in figure ⑦, pull ISOFIX setting key and push the baby car seat to make it fix to the car seat.

## 2. Top Tether Installation for Group I

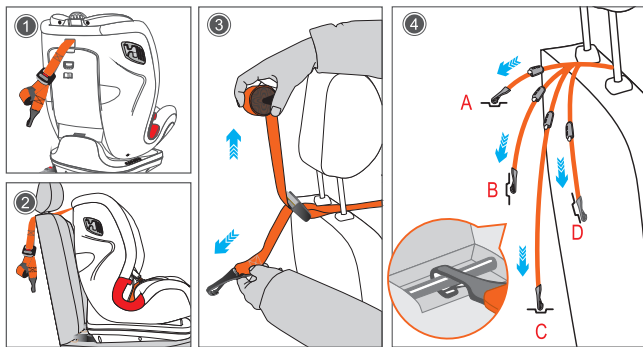

**Step 1:** Pull out the top tether and hook the user-ready anchorage behind (Refer to the User Manual from automaker). See figure ①②③④.

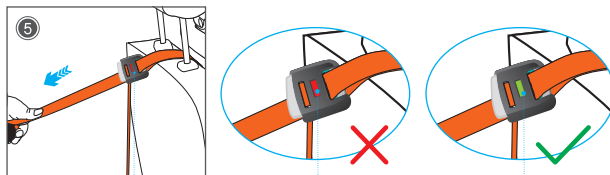

**Step 2:** Tighten the top tether until end of the strap release button show green. Meanwhile, wobble the car seat to check the top tether is tightened favorably and correctly. In order to release top tether, push the button to make top tether adjuster revolve some angle.

## 3. Harness Installation for Group I

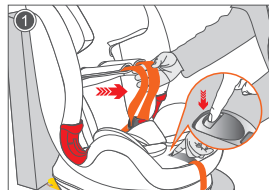

**Step 1:** Press the central adjuster and meanwhile, pull out the harness strap to release shoulder belt.

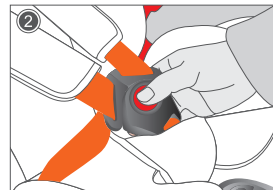

**Step 2:** Press the red button to open the harness buckle.

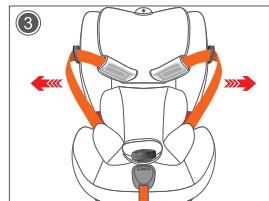

**Step 3:** Pull out both of the shoulder belt to both sides of the seat and insert buckle tongues into the fixed slots.

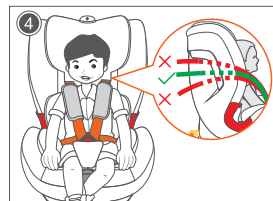

**Step 4:** Have your child sit on the seat to ensure the lap belt restrict the position of pelvis. Please check the shoulder height, the shoulder belts are required to place a little bit higher level of your child's shoulders. Too high or too low may reduce the safety of the children's restraining system.

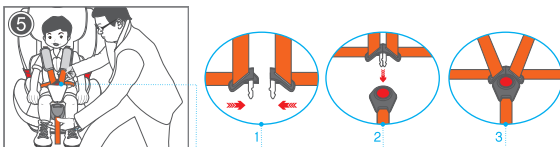

**Step 5:** Pull harness adjustment strap outward to fix child and avoid harness strap to constrict child too much. Adult palm can insert between harness strap and child's chest. Make sure the tightness is comfortable for your child and ensure the lap belt restrict the position of pelvis.

**Methods to use harness buckle:** guide the two buckle latches together and engage them before putting them into the harness buckle, this should make a click nose. The buckle latches will be released if you press the red button.

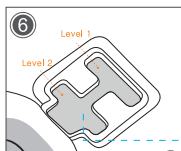

**Step 5:** In order to fit different somatotypes of children, there are two adjustable slots in the crotch parts. Before adjustment, loosen five-point safety belt and open buckle. Then twist the strap to go through a vertical slot and make sure buckle are fixed in the slot.

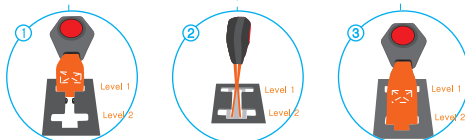

**Step 7:** Non-rethread harness system adjustable with headrest: according to different height of children, there are 4 levels to adjust the height of headrest and shoulder belt in Group 0+. Before adjustment, please loosen five-point safety belt. Attention: after sitting, adjust the headrest to the right position (PS: one or two fingers is the best distance from the bottom of headrest to child's shoulders).

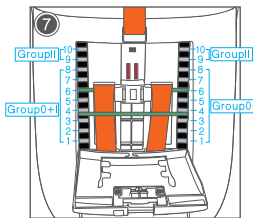

One or two fingers is the best distance from the bottom of headrest to child's shoulders.

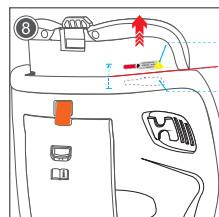

Higher than the base line for the side car seat body  
The base line for the side car seat body  
Lower than the base line for the side car seat body

**Step 8:** If the red line in the side of headrest exceeds the height of side car seat body, you should use Group II installation.

## 5-Point Harness Removal

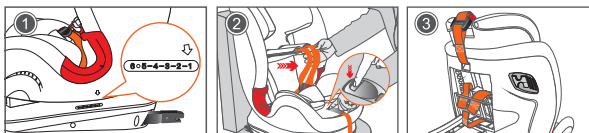

**Step 1:** As shown in figure ①, adjust the baby car seat to level 1.

**Step 2:** As shown in figure ②, push central adjuster and loosen the belt. Then, adjust headrest to level 3 or level 4 or level 5.

**Step 3:** As shown in figure ③, pull out top tether strap. Then, put top tether in the headrest temporarily and open the rear cover.

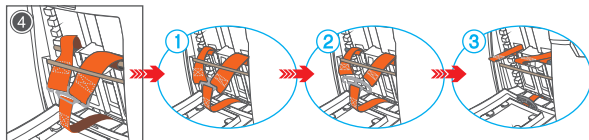

**Step 4:** As shown in figure ④, separate the shoulder belt with strap yoke: put strap yoke into the rear cover and draw out the belt forward.

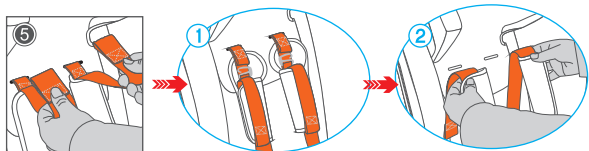

**Step 5:** As shown in figure ⑤, separate shoulder pads with belt: draw out shoulder pads firstly, open the shoulder pads and separate shoulder belts with strap yoke, then draw out the shoulder pads.

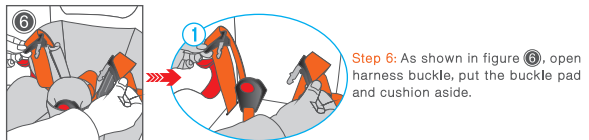

**Step 6:** As shown in figure ⑥, open harness buckle, put the buckle pad and cushion aside.

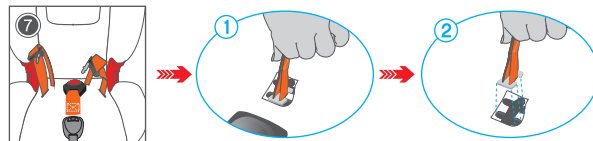

**Step 7:** As shown in figure ⑦, separate harness buckle and car seat (see 1&2).

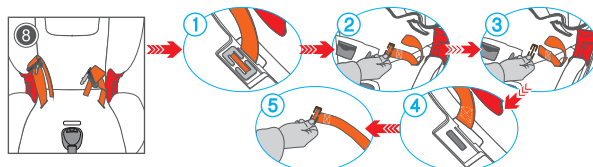

**Step 8:** As shown in figure ⑧, separate the strap with the seat: separate strap yoke from the seat by hands or small tools. Then draw out the belt and fix the strap yoke with the strap according to picture 1-2-3-4-5.

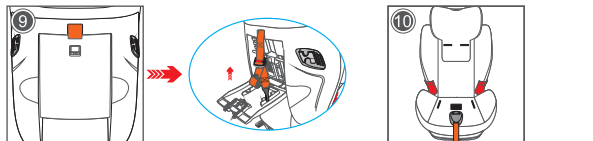

**Step 9:** As shown in figure ⑨, put the top tether into the rear cover and close it.

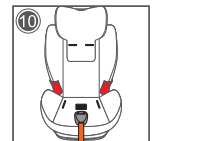

**Step 10:** As shown in figure ⑩, after baby car seat remove the 5-point safety belt.

### Notice

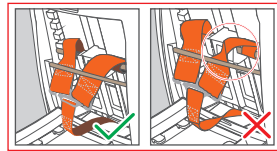

**Attention:** when you install shoulder belt and harness yoke, do not twist the strap.

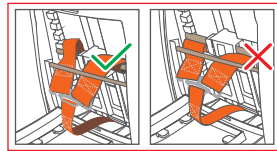

**Attention:** when you install shoulder belt and strap, you must make belts pass the harness shaft.

## Group II: Installation and Using method

### 1. Semi-Universal Installation: ISOFIT+3-point belt



#### Attention:

1. There is only one level for Group II and it is level 1.
2. Before using Group II, please remove the 5-point safety belt and cushion.
3. Pull the belt in the buckle tightly to make sure buckle in the right position.
4. Only suitable use in the listed vehicles fitted with 3-point belt and approved to GB14166 or ECE Regulation No. 16.
5. Only suitable use in the listed vehicles fitted with ISOFIX anchorages systems.
6. The installation for Group II is forward facing and is applied to children from 15 to 25kg.



**Step 1:** As shown in figure ①, before installation, place car seat forward facing, see user's manual page 11 to 12.

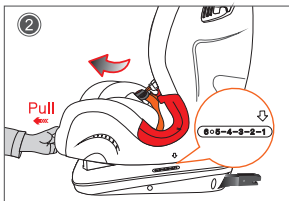

**Step 2:** As shown in figure ②, before installation, adjust the car seat to level 1.

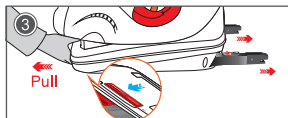

**Step 3:** As shown in figure ③, release ISOFIX connector. Pull ISOFIX setting key and ISOFIX connector will pop up automatically.

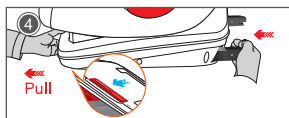

**Step 4:** As shown in figure ④, remove ISOFIX connectors. Pull ISOFIX setting key and push ISOFIX connectors into the base.

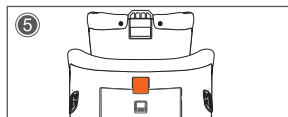

**Step 5:** As shown in figure ⑤, put the top tether into the rear cover.

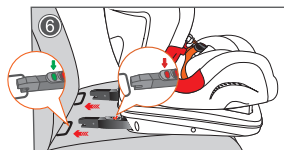

**Step 6:** As shown in figure ⑥, insert the two ISOFIX connectors firmly into the ISOFIX fixed point in the car seat with a "clicking" noise. In the meantime, ISOFIX indication window will become green. In order to release ISOFIX connectors, push the red button and the indication window will become red.

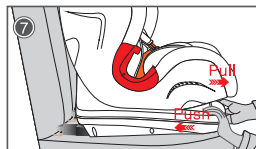

**Step 7:** As shown in figure ⑦, pull ISOFIX setting key and push the baby car seat to make it fix to the car seat.

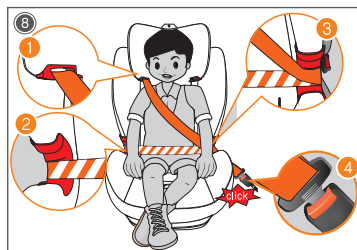

**Step 7:** As shown in figure ⑧, have your child sit on the seat and adjust headrest to the comfortable position. Then make the oblique belt through the guiding hook for Group II and III, horizontal belt through two harness guiders and insert car belt tongue to car buckle with click sound. Finally, make sure the lap belt can restrict the position of pelvis.

## 2. Universal Installation: 3-point belt



### Attention:

1. There is only one level for Group II and it is level 1.
2. Before using Group II, please remove the 5-point safety belt and cushion.
3. Pull the belt in the buckle tightly to make sure buckle in the right position.
4. Only suitable use in the listed vehicles fitted with 3-point belt and approved to GB14166 or ECE Regulation No. 16.
5. The installation for Group II is forward facing and is applied to children from 15 to 25kg.



**Step 1:** As shown in figure ①, before installation, place car seat forward facing, see user's manual page 11 to 12.

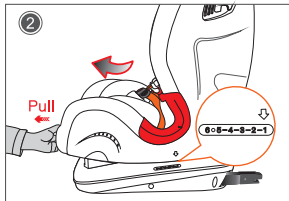

**Step 2:** As shown in figure ②, before installation, adjust the car seat to level 1.

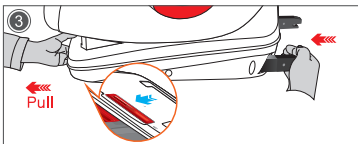

**Step 3:** As shown in figure ③, remove the ISOFIX connectors.

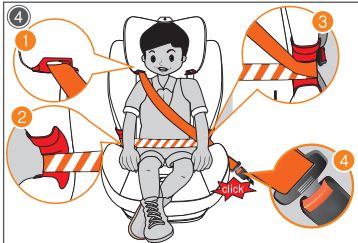

**Step 4:** As shown in figure ④, have your child sit on the seat and adjust headrest to the comfortable position. Then make the oblique belt through the guiding hook for Group II and III, horizontal belt through two harness guiders and insert car belt tongue to car buckle with click sound. Finally, make sure the lap belt can restrict the position of pelvis.

## Removing the cover

### 1. Removing the cover of car body

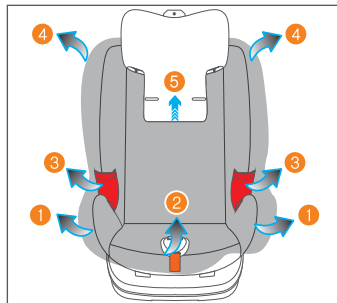

As shown in picture, remove the cover according to the order of 1, 2, 3, 4, 5.

### 2. Removing the cover of headrest

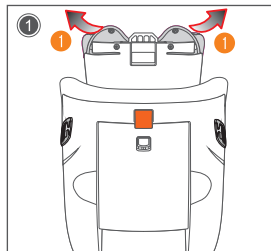

**Step 1:** As shown in figure 1, open the snap button in the headrest.

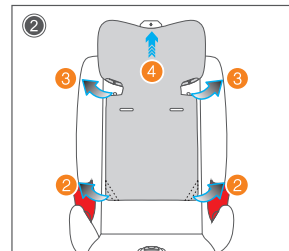

**Step 2:** As shown in figure 2, separate the elastic with the headrest. According to picture 3, separate elastic with the frame. Then, remove the cover as shown in Arrow 4.

**Attention:** When you are ready to refit, make the steps in the opposite order.

## Cleaning and Maintenance

- 1 Regularly check all important parts for damage. Make sure that the mechanical components in particular are all in perfect working order. If there is damage about your child safety seat in the event of an accident, in this case the safety seat must be replaced.
- 2 Store the child safety seat in a safe, dry place when it will not be used for an extended period of time.
- 3 Brush away loose debris using a soft bristled brush to clean the safety belt and plastic components, and then ventilate or dry them.
- 4 If food or beverage drips on your seat belt, thoroughly rinse it using warm water and then ventilate or dry it.
- 5 Remove and wash the cover see the instructions of cleaning.
- 6 If wash the cover in the first time, the cover might fade a little bit. It is a normal phenomenon.

## Washing Instructions

Do not use solvents, chemical cleaners and lubricants.



Hand Wash  
using the water  
under 30°



Do not Bleach



Do Not  
Machine Dry



Do not Iron