

### III. USE WARNING:

- Follow the manufacturer's instructions at all times.
- Regularly check screws, rivets, bolts and fastenings to ensure they are locked tight and secure.
- Be careful not to let the child climb out the guardrail or stand on the seat.
- Do not use the stroller in dangerous areas such as uneven ground or near the stove.
- Avoid use of storage in a wet, cold, or high temperature environment, away from fire, a source of fire or strong heat source.
- Any load attached to the handle and/or on the back of the backrest and/or on the sides of the stroller will affect the stability of it.
- The stroller shall be used only for one child for which it has been designed.
- Accessories which are not approved by the manufacturer shall not be used.

### IV. MAINTENANCE:

- To avoid risk of injury to your child, please check and maintain the stroller periodically.
- Hand wash seat fabric. Please take note that seat fabric is not suitable for machine wash.
- Cleaning of other parts: Use the damp cloth and wipe down.
- Check for loosen screws, damaged parts or tear in seat fabric. If necessary, replace the damaged parts promptly.



Moving  
to **EASY**

## INNOSPIN X Instruction Manual

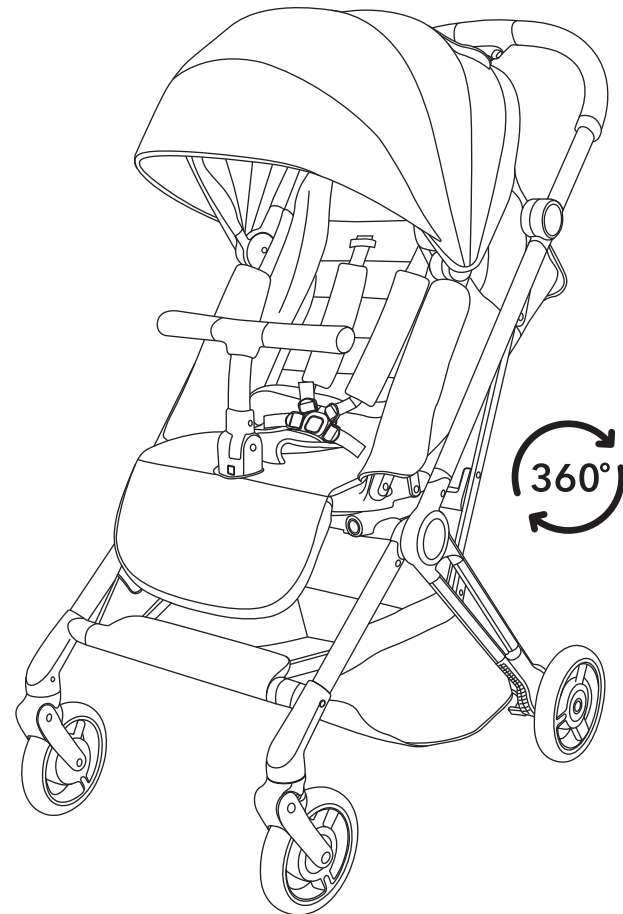

## PARTS LIST:



1. Canopy

2. Seat

3. Bumper Bar

4. Safety Buckle

5. Footrest

6. Front Wheels

7. Handle

8. Shoulder Pad

9. Rear Wheels

10. Shopping Basket

## II. USE INSTRUCTIONS:



### 1. Rotating the seat

- Adjust the backrest to upright position
- Lift up the footrest and pull the lever under it
- Rotate the seat to forward or rearward-facing

**WARNING: Do not rotate the seat when your baby in the stroller!**

*Remark: Do not leave seat in an unlocked position when using the stroller.*

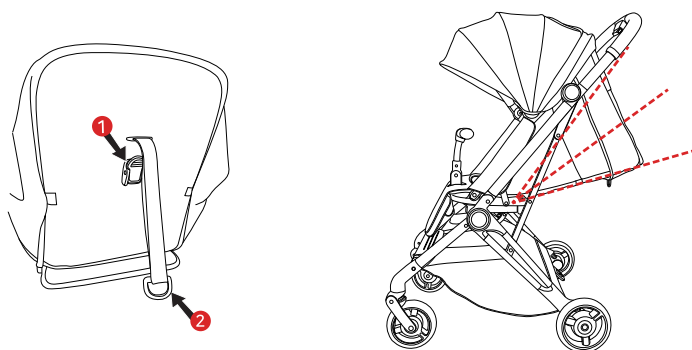

### 2. Adjust the backrest

Refer to arrow 1, the angle of backrest can be reclined by pulling down the adjusting lever behind the backrest.

Refer to arrow 2, lift the ring buckle on the adjustable belt, and pull upwards to lift the backrest. This backrest can be adjusted to multiple angles according to your preference.

## WARNING

Please follow these instructions carefully before using the stroller. This will guarantee safe usage of the product and enable you to find out about all its handy features.

- Never leave your child unattended.
- Never lift the stroller with the child inside it.
- Never adjust the stroller while your child is inside it.
- Ensure that all the locking devices are engaged before use.
- To avoid injury, ensure that your child is away when unfolding and folding this product.
- Do not let your child play with this product.
- Always use the restraint system / five-point harness.
- This product is not suitable for running or skating or any other sports activities.
- Not suitable for overnight sleeping. Your child may be at risk of serious harm or injury.
- Any load attached to the handle, backrest or sides affects the stability of the stroller.
- To avoid the risk of suffocation, keep all plastic bags and packaging out of reach from babies and young children.
- Never use the stroller on stairs or escalators with your child in it.
- Always check that the brake is fully engaged before letting go of your stroller.
- Never let your child climb into or out of the stroller alone.
- Keep away from fire!
- Check that the stroller body, seat unit or car seat attachment devices are correctly installed before use.
- This stroller is intended for children from 0 months to 36 months.
- This stroller is NOT suitable for children under 6 months when seat is in upright position.
- Maximum permitted weight for the stroller is 22kg. Maximum permitted weight for the shopping basket is 3kg.

## I. ASSEMBLING:

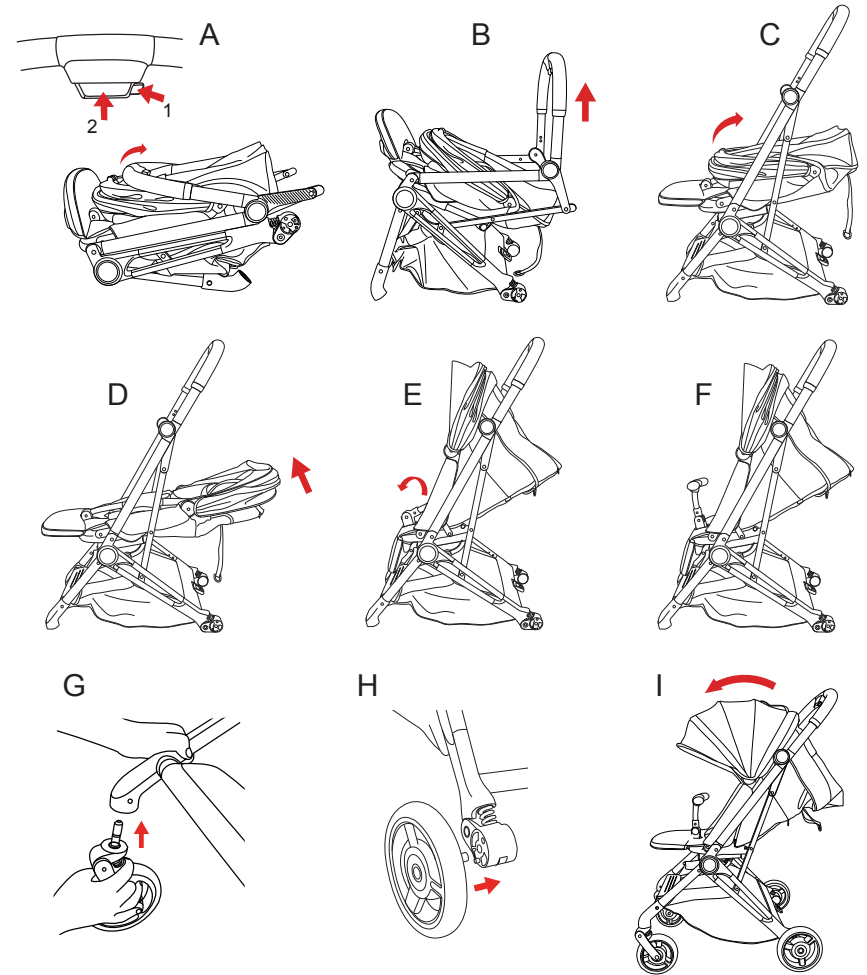

**Unfold the stroller:** Refer to diagram A, press button 1 follow by 2 and pull the stroller up until it unfolds completely as shown in diagram B.

**Unfold the seat:** Refer to diagram C&D, unfold the canopy and lift it upwards as shown in E. Lift up the front bar as shown in diagram F.

**Assemble the front wheels:** Refer to diagram G, insert front wheel into the catch until 'click' sound is heard.

**Assemble the rear wheels:** Refer to diagram H, insert the rear wheel axle into the catch until it fixed well.

### III. FOLD STROLLER:

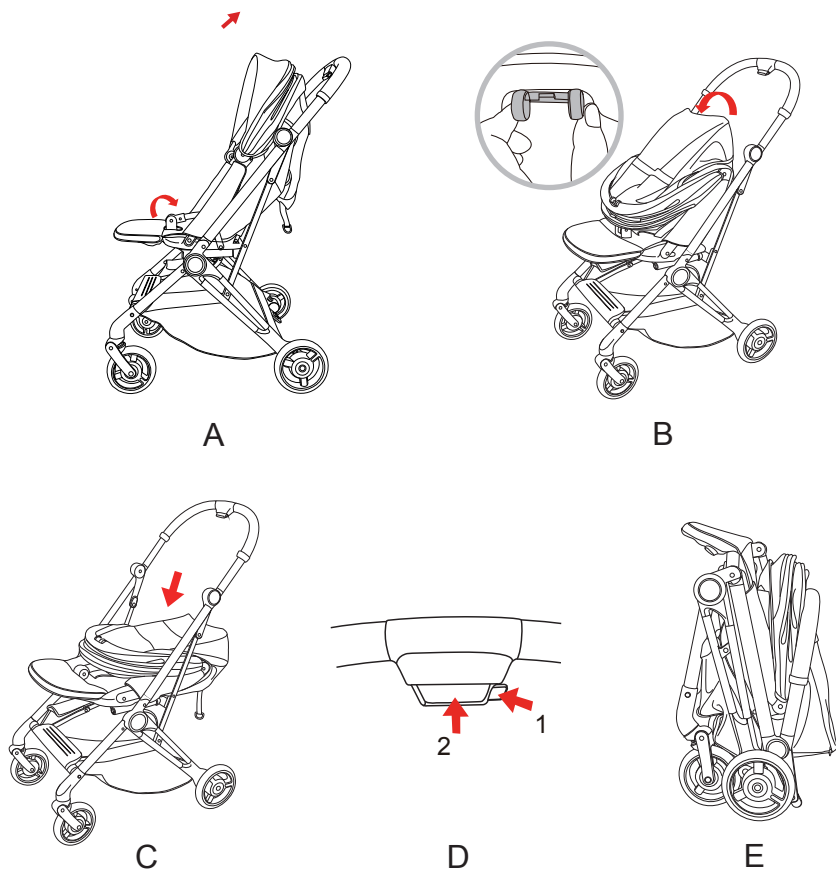

#### Folding

Refer to diagram A, fold the front bar and pinch the button at the back of the canopy to fold the canopy forward. Push the canopy down as shown in diagram B. Refer to diagram C, press button 1, follow by button 2 and push the handle forward and down until the stroller is automatically lock. Stroller is self-standing when locked properly.

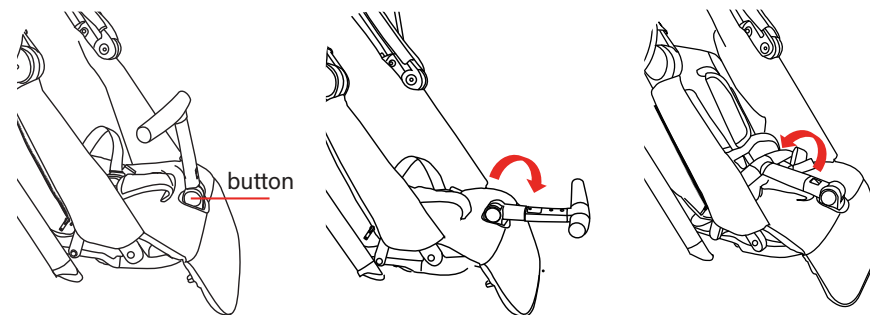

#### 3. Bumper bar

Push the round button on the bottom right of the bumper bar to fold it. Bumper bar can be folded inward and outward.

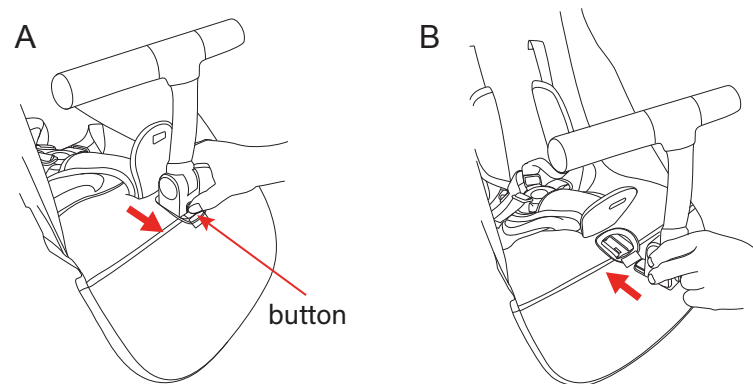

4. To remove bumper bar, refer to picture A: Press the button on the front side of the bumper bar and slide it outward. To attach bumper bar, refer to picture B: Insert the bumper bar into the socket under the seat until a 'click' sound is heard.

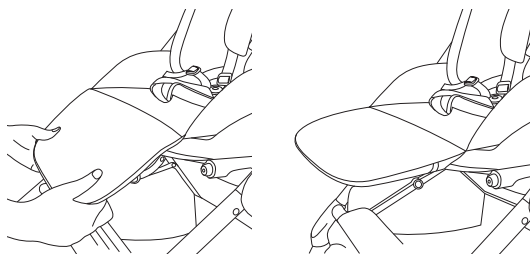

#### 5. Footrest

To adjust the legrest level:  
Press the button on both sides  
to lower down.

To lift up the footrest: Simply  
push it upwards.

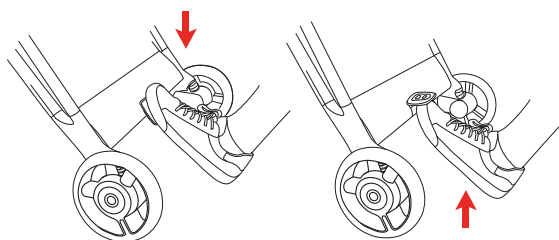

#### 6. Use Brake

To brake: Step the brake lever  
down until a 'click' sound is heard.

To release: Lift the brake lever up,  
until a 'click' sound is heard.

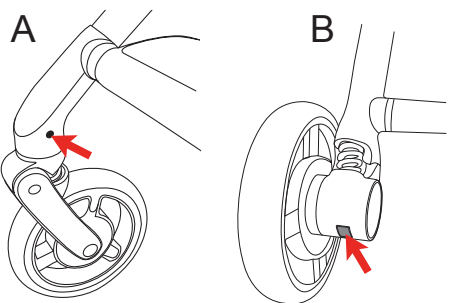

#### 7. Detach front wheel

Press the button on the inner  
side and pull out the front  
wheel to detach it.

#### 8. Detach rear wheel

Press the button on the under  
side and pull out the rear  
wheel to detach it.

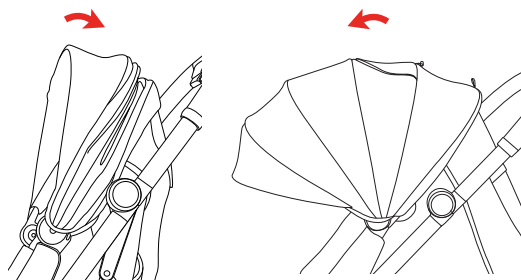

#### 9. Canopy

Pull the canopy forward or  
backward to open or keep the  
canopy.

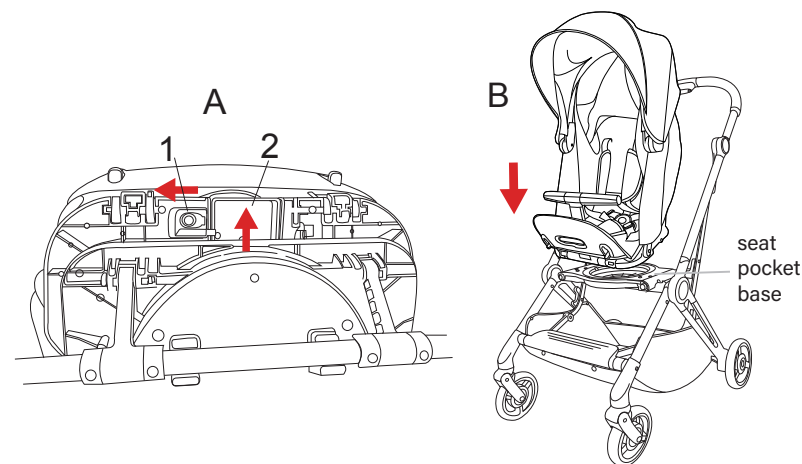

#### 10. Seat detach and assemble

Refer to image A, pull button 1 leftward on the bottom of the seat. At the same time, pull button 2 and detach the seat.

Refer to image B, align the seat with the seat base and insert it until a 'click' sound is heard.

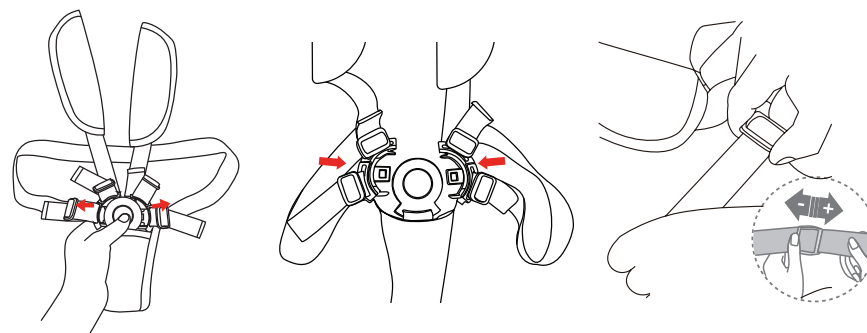

#### 11. Safety belt

Securing the seat belt: Attach the clips connected to the shoulder belt into the buckle until you hear the 'click' sound to make sure it is secured.

Releasing the seat belt: Press down the button in the middle of buckle, using the other hand to pull out both sides of the clip.

*Attention: Safety belt must be used at all times.*